

画地確定原子一覽表

画地面積	635.78 m ²
------	-----------------------

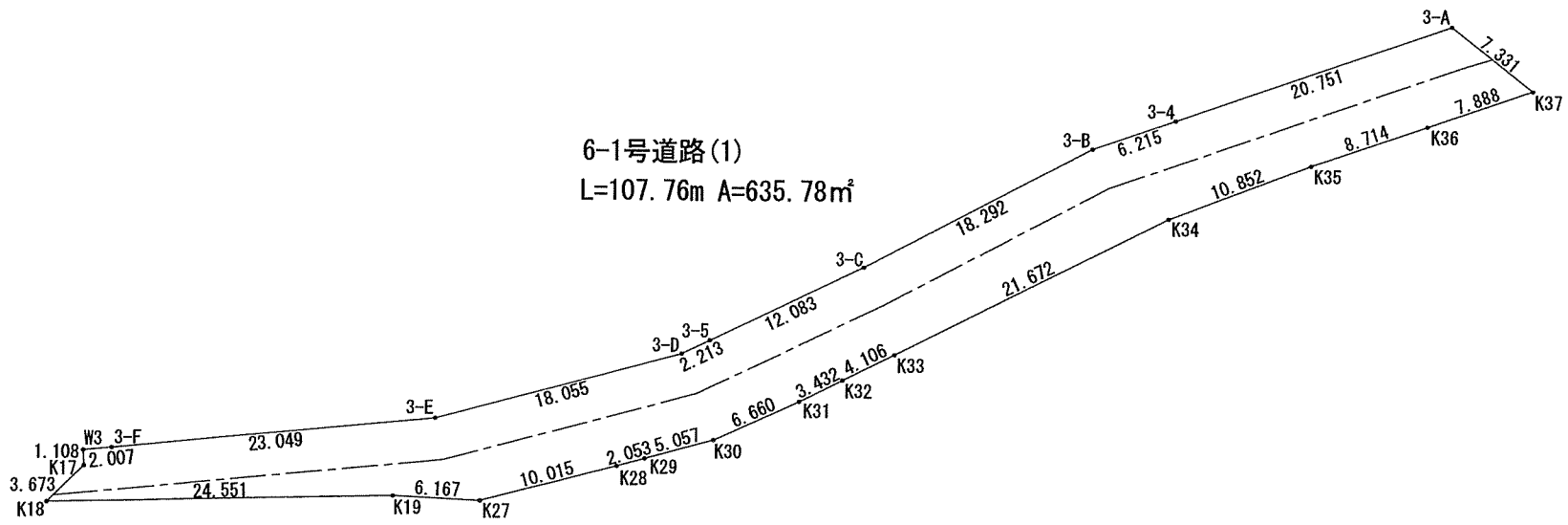

6-1号道路(1)
L=107.76m A=635.78m²



S=1:500

路線番号	6-1号道路(1)
------	-----------

画地確定原子一覽表

画地面積	582.50 m ²
------	-----------------------

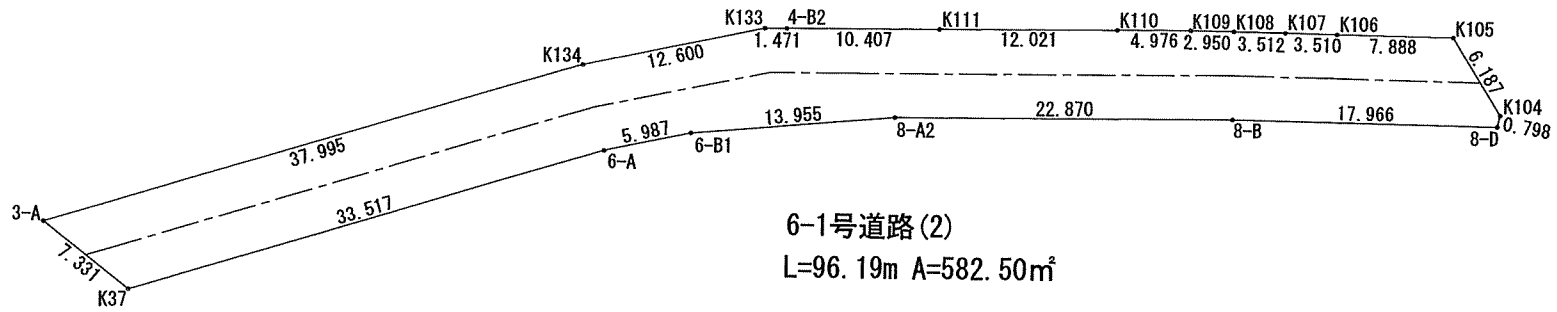
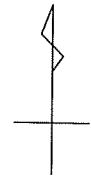

6-1号道路(2)
L=96.19m A=582.50m²

S=1:500

路線番号	6-1号道路(2)
------	-----------

面積 (座標法) 計算書

地番 : 6-1号道路(1)

測点名	[1] X(i)	[2] X(i+1)-X(i-1)	[3] Y(i)	[4] Y(i+1)-Y(i-1)	[2]*[3]	[1]*[4]	方向角	夾角	距離
3-F	-126888.433	-2.458	-13480.625	-24.936	33135.376250	3164089.965288	264-27-15	180-05-28	2.007
W3	-126888.627	-1.301	-13482.623	-1.944	17540.892523	246671.490888	177-12-26	92-45-11	1.108
K17	-126889.734	-3.681	-13482.569	-2.566	49629.336489	325599.057444	225-30-27	228-18-01	3.673
K18	-126892.308	-1.975	-13485.189	21.924	26633.248275	-2781986.960592	88-36-07	43-05-40	24.551
K19	-126891.709	0.305	-13460.645	30.704	-4105.496725	-3896083.033136	92-43-57	184-07-50	6.167
K27	-126892.003	2.260	-13454.485	15.844	-30407.136100	-2010476.895532	75-13-32	162-29-35	10.015
K28	-126889.449	3.098	-13444.801	11.664	-41651.993498	-1480038.533136	74-38-14	179-24-42	2.053
K29	-126888.905	1.883	-13442.821	6.857	-25312.831943	-870077.221585	74-38-51	180-00-37	5.057
K30	-126887.566	4.105	-13437.944	10.936	-55162.760120	-1387642.421776	65-27-46	170-48-55	6.660
K31	-126884.800	4.312	-13431.885	9.123	-57918.288120	-1157570.030400	63-13-33	177-45-47	3.432
K32	-126883.254	3.382	-13428.821	6.737	-45416.272622	-854812.482198	63-26-28	180-12-55	4.106
K33	-126881.418	11.578	-13425.148	23.032	-155436.363544	-2922332.819376	63-17-14	179-50-46	21.672
K34	-126871.676	13.606	-13405.789	29.500	-182399.165134	-3742714.442000	69-08-30	185-51-16	10.852
K35	-126867.812	6.718	-13395.648	18.374	-89991.963264	-2331069.177688	70-52-51	181-44-21	8.714
K36	-126864.958	5.436	-13387.415	15.686	-72773.987940	-1990003.731188	70-53-31	180-00-40	7.888
K37	-126862.376	7.105	-13379.962	1.683	-95064.630010	-213509.378808	308-05-32	57-12-01	7.331
3-A	-126857.853	-2.320	-13385.732	-25.360	31054.898240	3217115.152080	250-44-42	122-39-10	20.751
3-4	-126864.696	-8.892	-13405.322	-25.458	119200.123224	3229721.430768	250-45-06	180-00-24	6.215
3-B	-126866.745	-10.591	-13411.190	-22.043	142037.913290	2796523.660035	242-09-41	171-24-35	18.292
3-C	-126875.287	-13.768	-13427.365	-27.069	184867.961320	3434387.143803	244-22-20	182-12-39	12.083
3-5	-126880.513	-6.183	-13438.259	-12.889	83088.755397	1635362.932057	244-22-23	180-00-03	2.213
3-D	-126881.470	-5.656	-13440.254	-19.428	76018.076624	2465053.199160	254-54-53	190-32-30	18.055
3-E	-126886.169	-6.963	-13457.687	-40.371	93705.874581	5122521.528699	264-21-47	189-26-54	23.049
合計				倍面積	1271.567193	-1271.567193			225.944
				面積	635.7835965	635.7835965			
				地積	635.78	635.78			

面積 (座標法) 計算書

地番 : 6-1号道路(2)

測点名	[1] X(i)	[2] X(i+1)-X(i-1)	[3] Y(i)	[4] Y(i+1)-Y(i-1)	[2]*[3]	[1]*[4]	方向角	夾角	距離
3-A	-126857.853	-15.510	-13385.732	-30.602	207612.703320	3882104.017506	128-05-32	54-54-01	7.331
K37	-126862.376	5.171	-13379.962	37.855	-69187.783502	-4802375.243480	73-11-19	125-05-47	33.517
6-A	-126852.682	10.936	-13347.877	37.942	-145972.382872	-4813044.460444	78-01-39	184-50-20	5.987
6-B1	-126851.440	2.475	-13342.020	19.757	-33021.499500	-2506203.900080	84-55-51	186-54-12	13.955
8-A2	-126850.207	1.371	-13328.120	36.770	-18272.852520	-4664282.111390	89-39-15	184-43-24	22.870
8-B	-126850.069	-0.140	-13305.250	40.834	1862.735000	-5179795.717546	90-53-12	181-13-57	17.966
8-D	-126850.347	0.494	-13287.286	18.167	-6563.919284	-2304490.253949	14-43-57	103-50-45	0.798
K104	-126849.575	6.057	-13287.083	-3.014	-80479.861731	382324.619050	328-40-15	133-56-18	6.187
K105	-126844.290	5.401	-13290.300	-11.104	-71780.910300	1408478.996160	270-50-33	122-10-18	7.888
K106	-126844.174	0.167	-13298.187	-11.397	-2220.797229	1445643.051078	270-49-57	179-59-24	3.510
K107	-126844.123	0.102	-13301.697	-7.022	-1356.773094	890699.431706	270-49-55	179-59-58	3.512
K108	-126844.072	0.094	-13305.209	-6.462	-1250.689646	819666.393264	270-50-06	180-00-11	2.950
K109	-126844.029	0.003	-13308.159	-7.926	-39.924477	1005365.773854	269-32-22	178-42-16	4.976
K110	-126844.069	-0.134	-13313.135	-16.997	1783.960090	2155968.640793	269-33-07	180-00-45	12.021
K111	-126844.163	-0.181	-13325.156	-22.428	2411.853236	2844860.887764	269-31-16	179-58-09	10.407
4-B2	-126844.250	-0.092	-13335.563	-11.878	1226.871796	1506656.001500	269-48-19	180-17-03	1.471
K133	-126844.255	-2.616	-13337.034	-13.797	34889.680944	1750070.186235	258-02-24	168-14-05	12.600
K134	-126846.866	-13.598	-13349.360	-48.698	181524.597280	6177188.680468	253-11-31	175-09-07	37.995
合計				倍面積	1165.007511	-1165.007511			205.941
				面積	582.5037555	582.5037555			
				地積	582.50	582.50			

画地確定原子一覽表

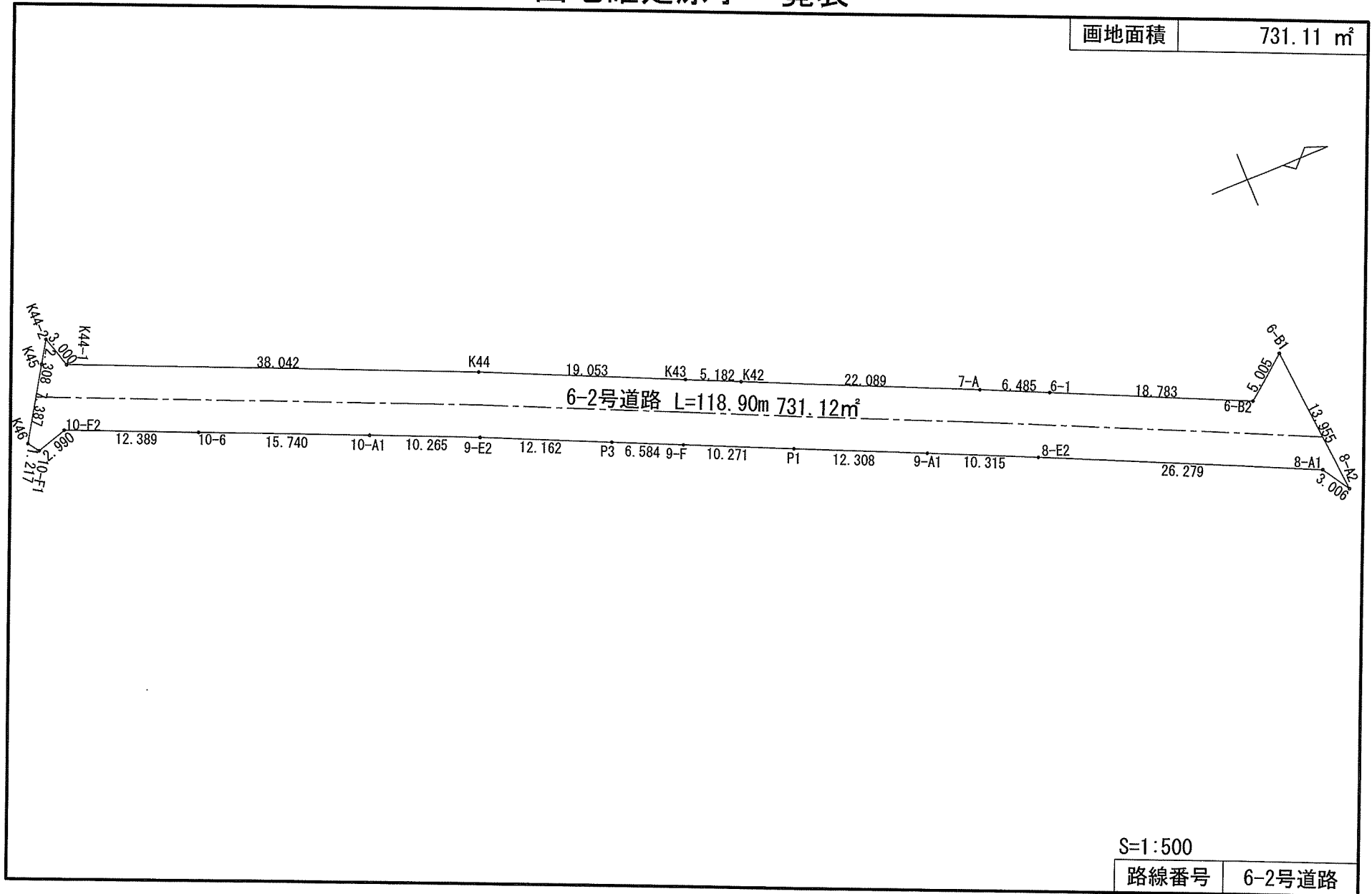

公共用地面積（座標法）計算書

地番： 6-2道路

測点名	[1] X (i)	[2] X (i+1)-X (i-1)	[3] Y (i)	[4] Y (i+1)-Y (i-1)	[2]*[3]	[1]*[4]	方向角	夾角	距離
6-B1	-126851.440	-5.145	-13342.020	-10.778	68644.692900	1367204.820320	141-24-29	56-28-38	5.005
6-B2	-126855.352	-17.212	-13338.898	-3.047	229589.112376	386528.257544	204-53-01	243-28-32	14.661
6-3	-126868.652	-17.039	-13345.067	-7.904	227386.596613	1002769.825408	204-53-33	180-00-32	4.122
6-1	-126872.391	-9.622	-13346.802	-4.464	128422.928844	566358.353424	204-53-08	179-59-35	6.485
7-A	-126878.274	-26.000	-13349.531	-11.851	347087.806000	1503634.425174	204-23-30	179-30-22	22.089
K42	-126898.391	-24.836	-13358.653	-11.264	331775.505908	1429383.476224	204-24-50	180-01-20	5.182
K43	-126903.110	-22.049	-13360.795	-10.060	294592.168955	1276645.286600	204-33-20	180-08-30	19.053
K44	-126920.440	-52.171	-13368.713	-23.193	697459.125923	2943665.764920	203-40-25	179-07-05	38.042
K44-1	-126955.281	-35.711	-13383.988	-18.146	477955.595468	2303730.529026	253-08-30	229-28-05	3.000
K44-2	-126956.151	-2.114	-13386.859	-0.927	28299.819926	117688.351977	122-36-57	49-28-27	2.308
K45	-126957.395	-5.233	-13384.915	8.161	70043.260195	-1036099.300595	122-41-07	180-04-10	7.387
K46	-126961.384	-3.286	-13378.698	7.210	43962.401628	-915391.578640	54-42-12	112-01-05	1.217
10-F1	-126960.681	3.572	-13377.705	0.151	-47785.162260	-19171.062831	343-38-38	108-56-26	2.990
10-F2	-126957.812	14.219	-13378.547	4.125	-190229.559793	-523700.974500	23-38-07	219-59-29	12.389
10-6	-126946.462	25.769	-13373.580	11.278	-344623.783020	-1431702.198436	23-38-18	180-00-11	15.740
10-A1	-126932.043	23.816	-13367.269	10.443	-318354.878504	-1325551.325049	23-44-09	180-05-51	10.265
9-E2	-126922.646	20.457	-13363.137	9.191	-273369.693609	-1166546.039386	24-34-48	180-50-39	12.162
P3	-126911.586	17.048	-13358.078	7.797	-227728.513744	-989529.636042	24-34-20	179-59-32	6.584
9-F	-126905.598	15.342	-13355.340	6.981	-204897.626280	-885927.979638	24-23-57	179-49-37	10.271
P1	-126896.244	20.563	-13351.097	9.326	-274538.607611	-1183434.371544	24-23-35	179-59-38	12.308
9-A1	-126885.035	20.581	-13346.014	9.391	-274674.314134	-1191577.363685	24-41-12	180-17-37	10.315
8-E2	-126875.663	33.215	-13341.706	15.358	-443144.764790	-1948556.432354	24-51-55	180-10-43	26.279
8-A1	-126851.820	25.456	-13330.656	13.586	-339345.179136	-1723408.826520	57-32-31	212-40-36	3.006
8-A2	-126850.207	0.380	-13328.120	-11.364	-5064.685600	1441525.752348	264-55-51	27-23-20	13.955
合計					1462.246255	-1462.246255			264.815
				倍面積	731.1231275	731.1231275			
				面積	731.12	731.12			
				地積					

画地確定原子一覽表

画地面積	705.16 m ²
------	-----------------------

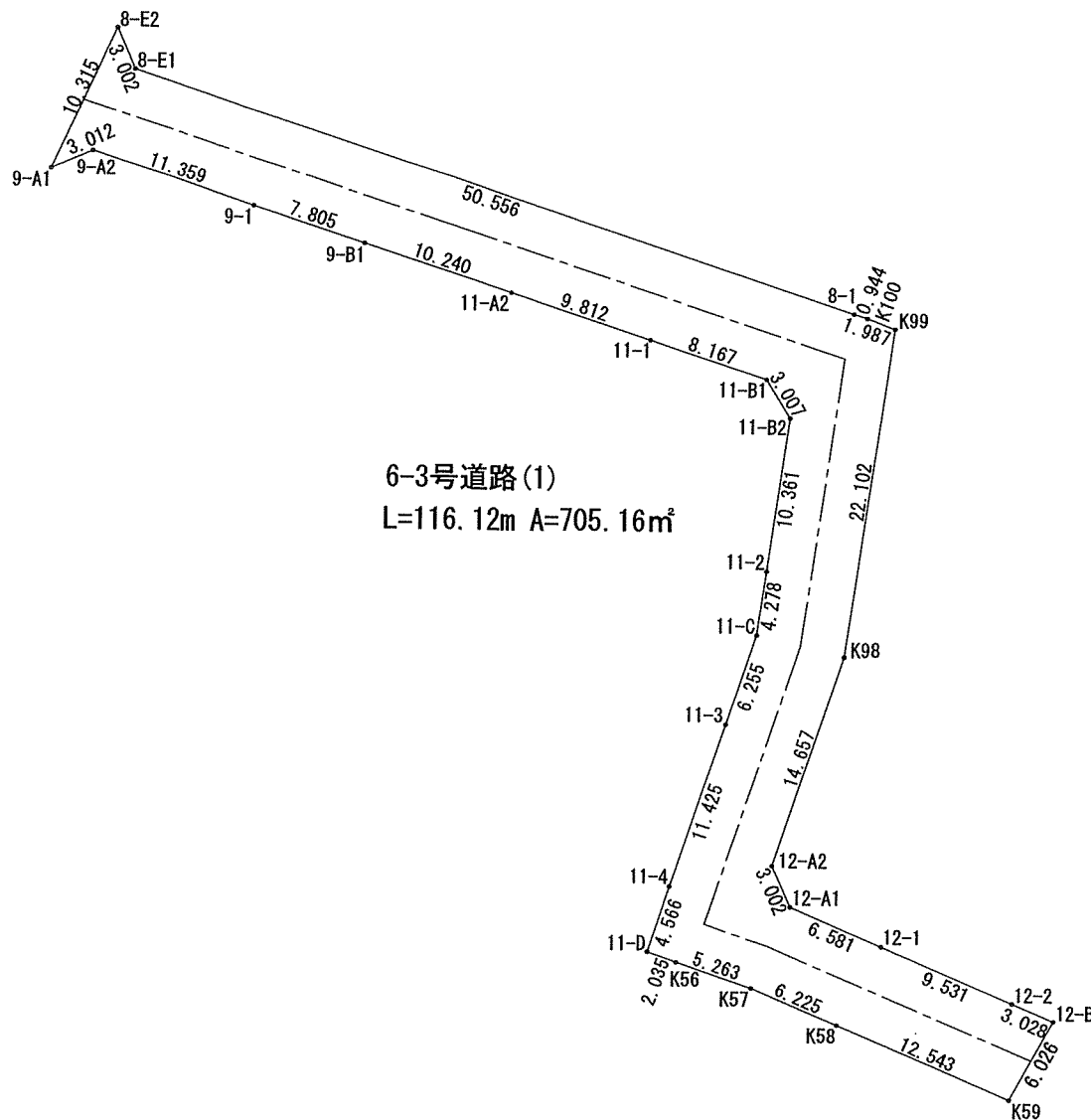

6-3号道路(1)
L=116.12m A=705.16m²

S=1:500

路線番号	6-3号道路(1)
------	-----------

面積 (座標法) 計算書

地番：道路6-3(1)

測点名	[1] X (i)	[2] X (i+1)-X (i-1)	[3] Y (i)	[4] Y (i+1)-Y (i-1)	[2]*[3]	[1]*[4]	方向角	夾角	距離
8-E1	-126878.413	18.275	-13340.502	-49.317	-243797.674050	6257262.693921	336-21-19	228-28-18	3.002
8-E2	-126875.663	-6.622	-13341.706	-5.512	88348.777132	699338.654456	204-41-12	48-19-53	10.315
9-A1	-126885.035	-8.167	-13346.014	-1.548	108996.896338	196418.034180	66-24-51	41-43-39	3.012
9-A2	-126883.830	-2.285	-13343.254	13.570	30489.335390	-1721813.573100	107-53-33	221-28-42	11.359
9-1	-126887.320	-5.888	-13332.444	18.237	78501.430272	-2314044.054840	107-53-38	180-00-05	7.805
9-B1	-126889.718	-5.547	-13325.017	17.171	73913.869299	-2178823.347778	107-54-34	180-00-56	10.240
11-A2	-126892.867	-6.157	-13315.273	19.084	81982.135861	-2421623.473828	107-51-05	179-56-31	9.812
11-1	-126895.875	-5.511	-13305.933	17.114	73328.996763	-2171696.004750	107-50-49	179-59-44	8.167
11-B1	-126898.378	-5.051	-13298.159	9.370	67169.001109	-1189037.801860	147-56-17	220-05-28	3.007
11-B2	-126900.926	-12.804	-13296.563	0.125	170249.192652	-15862.615750	188-09-44	220-13-27	10.361
11-2	-126911.182	-14.491	-13298.034	-2.078	192701.810694	263721.436196	188-09-24	179-59-40	4.278
11-C	-126915.417	-10.169	-13298.641	-2.585	135233.880329	328076.352945	198-26-06	190-16-42	6.255
11-3	-126921.351	-16.772	-13300.619	-5.592	223077.981868	709744.194792	198-26-29	180-00-23	11.425
11-4	-126932.189	-15.170	-13304.233	-5.058	201825.214610	642023.011962	198-26-06	179-59-37	4.566
11-D	-126936.521	-5.007	-13305.677	0.476	66621.524739	-60421.783996	109-22-11	90-56-05	2.035
K56	-126937.196	-2.339	-13303.757	6.913	31117.487623	-877516.835948	108-25-53	179-03-42	5.263
K57	-126938.860	-4.081	-13298.764	10.730	54272.255884	-1362053.967800	112-50-45	184-24-52	6.225
K58	-126941.277	-7.288	-13293.027	17.296	96879.580776	-2195576.326992	112-51-03	180-00-18	12.543
K59	-126946.148	0.401	-13281.468	14.478	-5325.868668	-1837926.330744	28-58-21	96-07-18	6.026
12-B	-126940.876	6.448	-13278.549	0.129	-85620.083952	-16375.373004	292-51-20	83-52-59	3.028
12-2	-126939.700	4.879	-13281.339	-11.572	-64799.652981	1468946.208400	292-51-47	180-00-27	9.531
12-1	-126935.997	6.260	-13290.121	-14.846	-83196.157460	1884491.811462	292-51-49	180-00-02	6.581
12-A1	-126933.440	5.290	-13296.185	-7.306	-70336.818650	927375.712640	335-33-39	222-41-50	3.002
12-A2	-126930.707	16.634	-13297.427	3.405	-221189.400718	-432199.057335	18-29-04	222-55-25	14.657
K98	-126916.806	35.778	-13292.780	7.795	-475589.082840	-989316.502770	8-11-18	169-42-14	22.102
K99	-126894.929	22.578	-13289.632	1.289	-300053.311296	-163567.563481	290-39-38	102-28-20	1.987
K100	-126894.228	0.991	-13291.491	-2.757	-13171.867581	349847.386596	287-53-50	177-14-12	0.944
8-1	-126893.938	15.815	-13292.389	-49.011	-210219.132035	6219198.795318	287-53-01	179-59-11	50.556
合計				倍面積	1410.321108	-1410.321108			248.084
				面積	705.1605540	705.1605540			
				地積	705.16	705.16			

画地確定原子一覽表

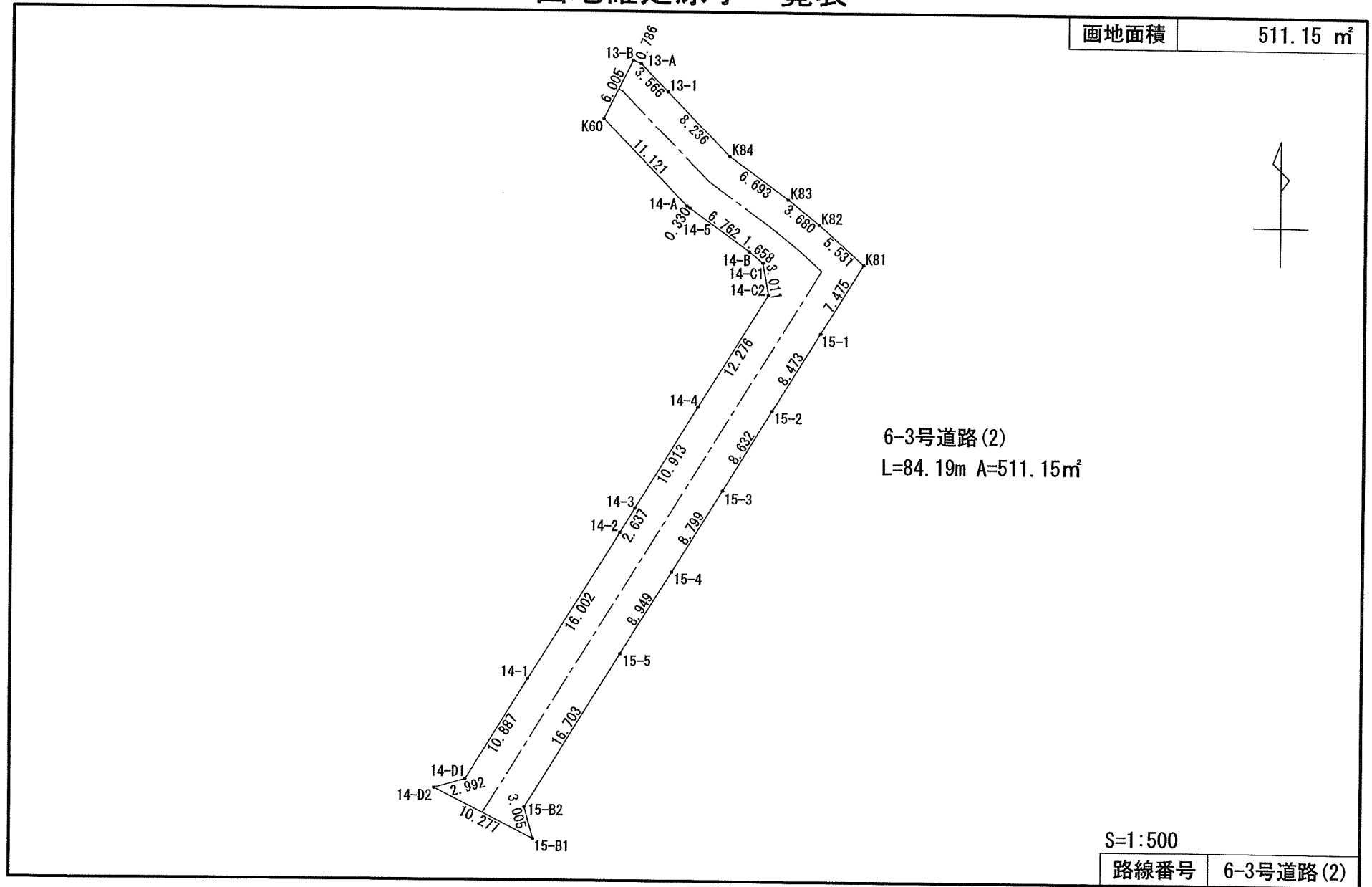

面積 (座標法) 計算書

地番 : 6-3号道路(2)

測点名	[1] X(i)	[2] X(i+1)-X(i-1)	[3] Y(i)	[4] Y(i+1)-Y(i-1)	[2]*[3]	[1]*[4]	方向角	夾角	距離
K60	-126947.914	-13.309	-13277.276	5.068	176707.266284	-643372.028152	135-37-49	108-48-48	11.121
14-A	-126955.864	-8.141	-13269.499	8.046	108026.991359	-1021486.881744	125-22-34	169-44-45	0.330
14-5	-126956.055	-4.119	-13269.230	5.773	54655.958370	-732917.305515	125-30-51	180-08-17	6.762
14-B	-126959.983	-4.954	-13263.726	6.807	65708.498604	-864216.604281	128-13-03	182-42-12	1.658
14-C1	-126961.009	-3.991	-13262.423	1.825	52930.330193	-231703.841425	170-00-55	221-47-52	3.011
14-C2	-126963.974	-13.408	-13261.901	-5.932	177815.568608	753150.293768	211-43-01	221-42-06	12.276
14-4	-126974.417	-19.726	-13268.355	-12.191	261731.570730	1547945.117647	211-43-00	179-59-59	10.913
14-3	-126983.700	-11.526	-13274.092	-7.124	152997.184392	904631.878800	211-43-53	180-00-53	2.637
14-2	-126985.943	-15.856	-13275.479	-9.799	210495.995024	1244335.255457	211-42-49	179-58-56	16.002
14-1	-126999.556	-22.874	-13283.891	-14.136	303855.722734	1795265.723616	211-43-09	180-00-20	10.887
14-D1	-127008.817	-10.075	-13289.615	-8.603	133892.871125	1092656.852651	254-12-45	222-29-36	2.992
14-D2	-127009.631	-5.439	-13292.494	6.299	72297.874866	-800033.665669	116-44-40	42-31-55	10.277
15-B1	-127014.256	-1.733	-13283.316	8.362	23019.986628	-1062093.208672	344-14-35	47-29-55	3.005
15-B2	-127011.364	17.104	-13284.132	7.960	-227211.793728	-1011010.457440	31-41-44	227-27-09	16.703
15-5	-126997.152	21.826	-13275.356	13.478	-289747.920056	-1711667.614656	31-41-50	180-00-06	8.949
15-4	-126989.538	15.101	-13270.654	9.325	-200400.146054	-1184177.441850	31-41-39	179-59-49	8.799
15-3	-126982.051	14.832	-13266.031	9.158	-196761.771792	-1162901.623058	31-41-32	179-59-53	8.632
15-2	-126974.706	14.554	-13261.496	8.987	-193007.812784	-1141121.682822	31-41-52	180-00-20	8.473
15-1	-126967.497	13.569	-13257.044	8.380	-179884.830036	-1063987.624860	31-42-00	180-00-08	7.475
K81	-126961.137	10.043	-13253.116	-0.199	-133101.043988	25265.266263	311-44-46	100-02-46	5.531
K82	-126957.454	5.958	-13257.243	-7.019	-78986.653794	891114.369626	308-11-26	176-26-40	3.680
K83	-126955.179	6.165	-13260.135	-8.339	-81748.732275	1058679.237681	305-31-58	177-20-32	6.693
K84	-126951.289	9.771	-13265.582	-11.213	-129618.001722	1423504.803557	315-33-57	190-01-59	8.236
13-1	-126945.408	8.429	-13271.348	-8.261	-111864.192292	1048696.015488	315-36-08	180-02-11	3.566
13-A	-126942.860	2.853	-13273.843	-3.219	-37870.274079	408629.066340	292-50-39	157-14-31	0.786
13-B	-126942.555	-5.054	-13274.567	-3.433	67089.661618	435793.791315	206-49-01	93-58-22	6.005
合計				倍面積	1022.307935	-1022.307935			185.399
				面積	511.1539675	511.1539675			
				地積	511.15	511.15			

画地確定原子一覽表

画地面積	497.30 m ²
------	-----------------------

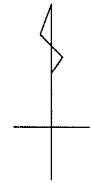
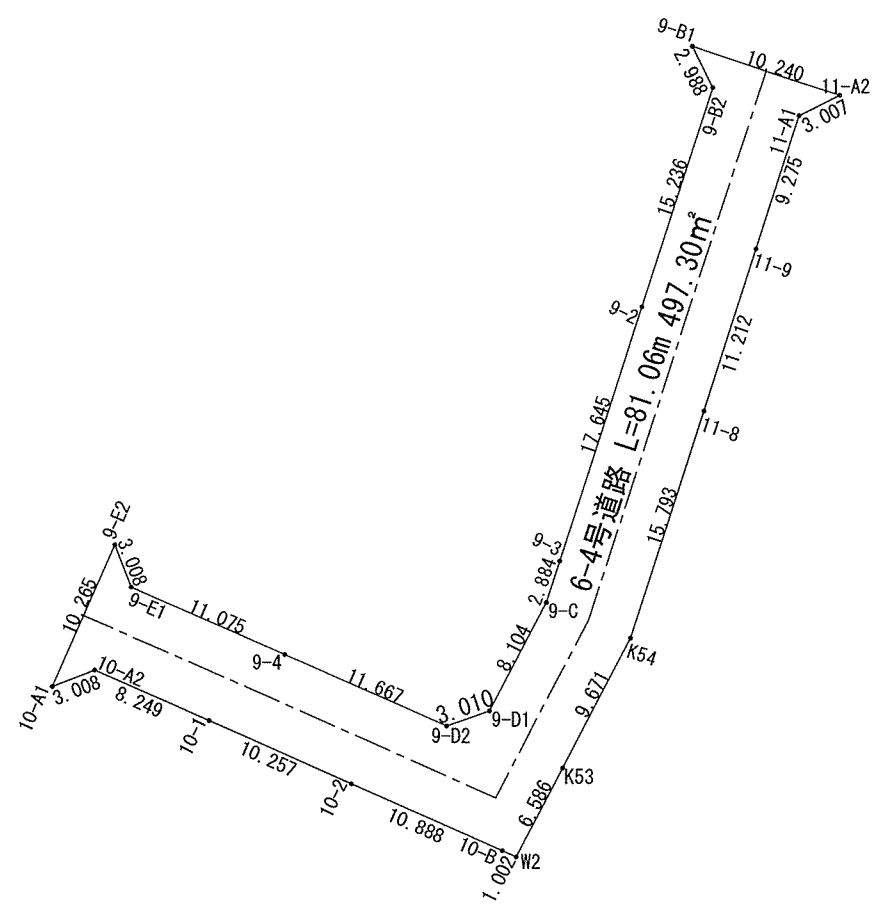

S=1:500

路線番号	6-4号道路
------	--------

公共用地面積（座標法）計算書

画地番号： 道路6-4

測点名	[1] X(i)	[2] X(i+1)-X(i-1)	[3] Y(i)	[4] Y(i+1)-Y(i-1)	[2]*[3]	[1]*[4]	方向角	夾角	距離
9-B1	-126889.718	0.491	-13325.017	-8.379	-6542.583347	1063208.947122	152-49-03	44-54-29	2.988
9-B2	-126892.376	-17.158	-13323.652	-3.314	228607.221016	420521.334064	197-53-04	225-04-01	15.236
9-2	-126906.876	-31.293	-13328.331	-10.096	417083.461983	1281251.820096	197-52-42	179-59-38	17.645
9-3	-126923.669	-19.538	-13333.748	-6.303	260514.768424	799999.885707	197-53-18	180-00-36	2.884
9-C	-126926.414	-9.926	-13334.634	-4.643	132359.577084	589319.340202	207-37-05	189-43-47	8.104
9-D1	-126933.595	-8.172	-13338.391	-6.599	109001.331252	837634.793405	250-46-35	223-09-30	3.010
9-D2	-126934.586	3.694	-13341.233	-13.527	-49282.514702	1717044.144822	293-40-33	222-53-58	11.667
9-4	-126929.901	9.131	-13351.918	-20.828	-121916.363258	2643695.978028	293-40-10	179-59-37	11.075
9-E1	-126925.455	7.255	-13362.061	-11.219	-96941.752555	1423976.679645	339-02-26	225-22-16	3.008
9-E2	-126922.646	-6.588	-13363.137	-5.208	88036.346556	661013.140368	203-44-09	44-41-43	10.265
10-A1	-126932.043	-8.306	-13367.269	-1.329	111028.536314	168692.685147	68-43-58	44-59-49	3.008
10-A2	-126930.952	-2.221	-13364.466	10.358	29682.478986	-1314750.800816	113-40-19	224-56-21	8.249
10-1	-126934.264	-7.429	-13356.911	16.949	99228.491819	-2151408.840536	113-39-57	179-59-38	10.257
10-2	-126938.381	-8.489	-13347.517	19.366	113307.071813	-2458288.686446	113-40-26	180-00-29	10.888
10-B	-126942.753	-4.774	-13337.545	10.890	63673.439830	-1382406.580170	113-38-56	179-58-30	1.002
W2	-126943.155	5.432	-13336.627	3.975	-72444.557864	-504599.041125	27-39-16	94-00-20	6.586
K53	-126937.321	14.401	-13333.570	7.545	-192016.741570	-957742.086945	27-38-55	179-59-39	9.671
K54	-126928.754	23.599	-13329.082	9.331	-314553.006118	-1184372.203574	17-51-28	170-12-33	15.793
11-8	-126913.722	25.704	-13324.239	8.281	-342486.239256	-1050972.531882	17-51-23	179-59-55	11.212
11-9	-126903.050	19.500	-13320.801	6.282	-259755.619500	-797204.960100	17-51-24	180-00-01	9.275
11-A1	-126894.222	10.183	-13317.957	5.528	-135616.756131	-701471.259216	63-12-48	225-21-24	3.007
11-A2	-126892.867	4.504	-13315.273	-7.060	-59971.989592	895863.641020	287-54-34	44-41-46	10.240
合計					994.601184	-994.601184			185.070
				倍面積	497.3005920	497.3005920			
				面積	497.30	497.30			
				地積					

画地確定原子一覽表

画地面積	24.59 m ²
------	----------------------

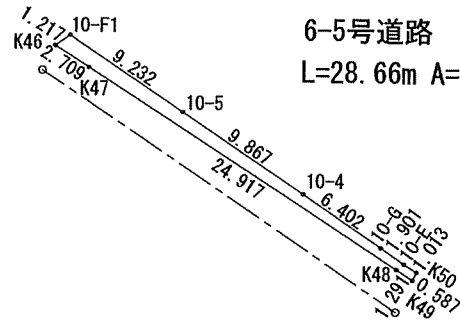
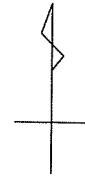

S=1:500

路線番号	6-5号道路
------	--------

画地確定原子一覽表

画地面積	225.97 m ²
------	-----------------------

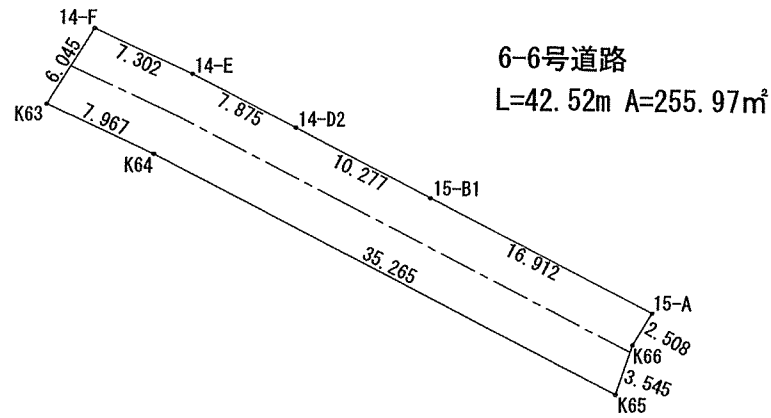
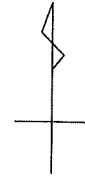

S=1:500

路線番号	6-6号道路
------	--------

面積 (座標法) 計算書

地番 : 6-5号道路

測点名	[1] X(i)	[2] X(i+1)-X(i-1)	[3] Y(i)	[4] Y(i+1)-Y(i-1)	[2]*[3]	[1]*[4]	方向角	夾角	距離
10-F1	-126960.681	4.430	-13377.705	-8.666	-59263.233150	1100241.261546	234-42-12	110-55-19	1.217
K46	-126961.384	-2.163	-13378.698	1.289	28938.123774	-163653.223976	122-36-38	67-54-26	2.709
K47	-126962.844	-14.924	-13376.416	23.248	199629.632384	-2951632.197312	122-42-28	180-05-50	24.917
K48	-126976.308	-14.162	-13355.450	22.052	189139.882900	-2800081.544016	122-43-48	180-01-20	1.291
K49	-126977.006	-0.178	-13354.364	1.358	2377.076792	-172434.774148	27-36-47	84-52-59	0.587
K50	-126976.486	1.064	-13354.092	-0.583	-14208.753888	74027.291338	302-28-01	94-51-14	1.013
10-E	-126975.942	1.627	-13354.947	-2.417	-21728.498769	306900.851814	304-44-07	182-16-06	1.901
10-G	-126974.859	4.642	-13356.509	-6.884	-62000.914778	874094.929356	303-46-19	179-02-12	6.402
10-4	-126971.300	9.045	-13361.831	-13.523	-120857.761395	1717032.889900	303-46-49	180-00-30	9.867
10-5	-126965.814	10.619	-13370.032	-15.874	-141976.369808	2015455.331436	303-46-53	180-00-04	9.232
合計				倍面積	49.184062	-49.184062			59.136
				面積	24.5920310	24.5920310			
				地積	24.59	24.59			

面積 (座標法) 計算書

地番 : 6-6号道路

測点名	[1] X(i)	[2] X(i+1)-X(i-1)	[3] Y(i)	[4] Y(i+1)-Y(i-1)	[2]*[3]	[1]*[4]	方向角	夾角	距離
14-F	-127003.081	-2.125	-13306.182	-9.843	28275.636750	1250091.326283	211-50-59	97-30-23	6.045
K63	-127008.216	-8.426	-13309.372	4.066	112144.768472	-516415.406256	114-23-49	82-32-50	7.967
K64	-127011.507	-19.157	-13302.116	38.750	254828.636212	-4921695.896250	116-44-17	182-20-28	35.265
K65	-127027.373	-12.503	-13270.622	32.614	165922.586866	-4142870.743022	18-25-11	81-40-54	3.545
K66	-127024.010	5.513	-13269.502	2.412	-73154.764526	-306381.912120	31-00-11	192-35-00	2.508
15-A	-127021.860	9.754	-13268.210	-13.814	-129418.120340	1754679.974040	296-43-11	85-43-00	16.912
15-B1	-127014.256	12.229	-13283.316	-24.284	-162441.671364	3084414.192704	296-44-40	180-01-29	10.277
14-D2	-127009.631	8.165	-13292.494	-16.213	-108533.213510	2059207.147403	296-42-41	179-58-01	7.875
14-E	-127006.091	6.550	-13299.529	-13.688	-87111.914950	1738459.373608	294-20-36	177-37-55	7.302
合計				倍面積	511.943610	-511.943610			97.696
				面積	255.9718050	255.9718050			
				地積	255.97	255.97			

画地確定原子一覽表

画地面積 62.54 m²

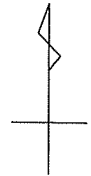

4-1号道路
L=69.69m A=62.54m²

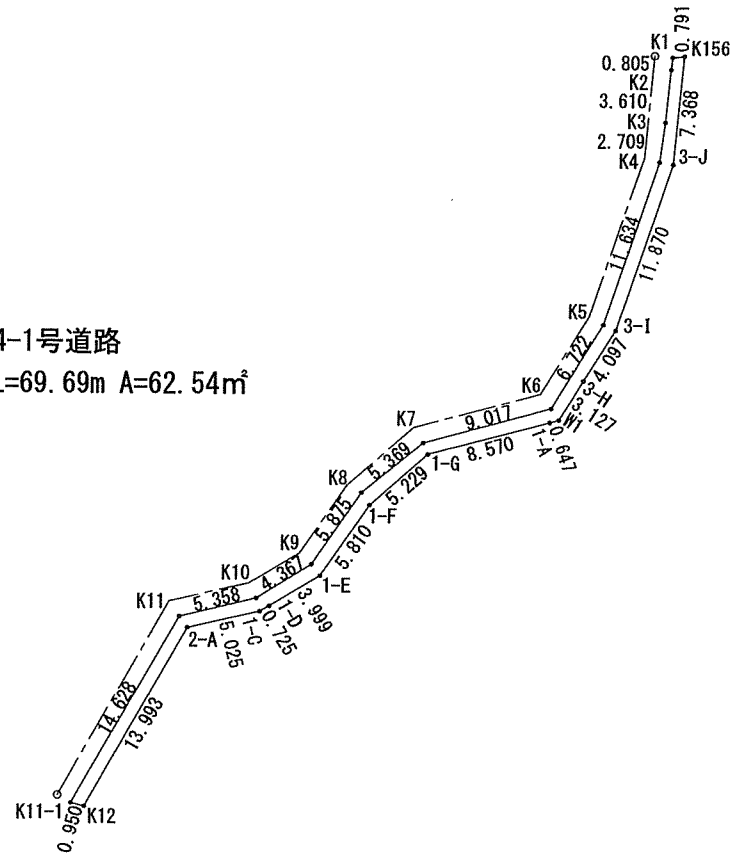

S=1:500

路線番号 4-1号道路

面積（座標法）計算書

地番： 4-1号道路

測点名	[1] X(i)	[2] X(i+1)-X(i-1)	[3] Y(i)	[4] Y(i+1)-Y(i-1)	[2]*[3]	[1]*[4]	方向角	夾角	距離
K1	-126800.916	-0.899	-13475.297	-0.882	12114.292003	111838.407912	186-55-19	104-10-54	0.805
K2	-126801.715	-4.389	-13475.394	-0.473	59143.504266	59977.211195	185-58-45	179-03-26	3.610
K3	-126805.305	-6.271	-13475.770	-0.762	84506.553670	96625.642410	188-11-35	182-12-50	2.709
K4	-126807.986	-13.692	-13476.156	-4.143	184515.527952	525365.485998	198-50-23	190-38-48	11.634
K5	-126818.997	-16.738	-13479.913	-7.277	225626.783794	922861.841169	211-34-34	192-44-11	6.722
K6	-126824.724	-8.127	-13483.433	-12.212	109579.859991	1548783.529488	254-33-52	222-59-18	9.017
K7	-126827.124	-5.792	-13492.125	-12.854	78146.388000	1630235.851896	230-49-13	156-15-21	5.369
K8	-126830.516	-8.232	-13496.287	-7.492	111101.434584	950214.225872	214-31-43	163-42-30	5.875
K9	-126835.356	-7.142	-13499.617	-7.041	96414.264614	893047.741596	238-11-17	203-39-34	4.367
K10	-126837.658	-3.555	-13503.328	-8.920	48004.331040	1131391.909360	256-28-29	198-17-12	5.358
K11	-126838.911	-13.903	-13508.537	-12.555	187809.189911	1592462.527605	210-08-39	133-40-10	14.628
K11-1	-126851.561	-12.886	-13515.883	-6.426	174165.668338	815148.130986	104-23-15	74-14-36	0.950
K12	-126851.797	11.895	-13514.963	7.894	-160760.484885	-1001368.085518	29-53-39	105-30-24	13.993
2-A	-126839.666	13.247	-13507.989	11.874	-178940.330283	-1506094.194084	77-10-10	227-16-31	5.025
1-C	-126838.550	1.487	-13503.089	5.523	-20079.093343	-700529.311650	59-13-33	162-03-23	0.725
1-D	-126838.179	2.422	-13502.466	4.056	-32702.972652	-514455.654024	59-08-40	179-55-07	3.999
1-E	-126836.128	6.833	-13499.033	6.733	-92238.892489	-853987.649824	34-36-33	155-27-53	5.810
1-F	-126831.346	8.232	-13495.733	7.229	-111096.874056	-916863.800234	48-42-51	194-06-18	5.229
1-G	-126827.896	5.673	-13491.804	12.206	-76539.004092	-1548061.298576	74-57-59	206-15-08	8.570
1-A	-126825.673	2.391	-13483.527	8.902	-32239.113057	-1129002.141046	74-57-16	179-59-17	0.647
W1	-126825.505	2.819	-13482.902	2.284	-38008.300738	-289669.453420	32-02-18	137-05-02	3.127
3-H	-126822.854	6.124	-13481.243	3.832	-82559.132132	-485985.176528	32-02-01	179-59-43	4.097
3-I	-126819.381	14.705	-13479.070	6.013	-198209.724350	-762564.937953	18-52-28	166-50-27	11.870
3-J	-126808.149	18.565	-13475.230	4.558	-250167.644950	-577991.543142	5-35-32	166-43-04	7.368
K156	-126800.816	7.233	-13474.512	-0.067	-97461.145296	8495.654672	262-44-25	77-08-53	0.791
合計					倍面積 面積 地積	125.085840 62.5429200 62.54			142.295

画地確定原子一覽表

画地面積	697.36 m ²
------	-----------------------

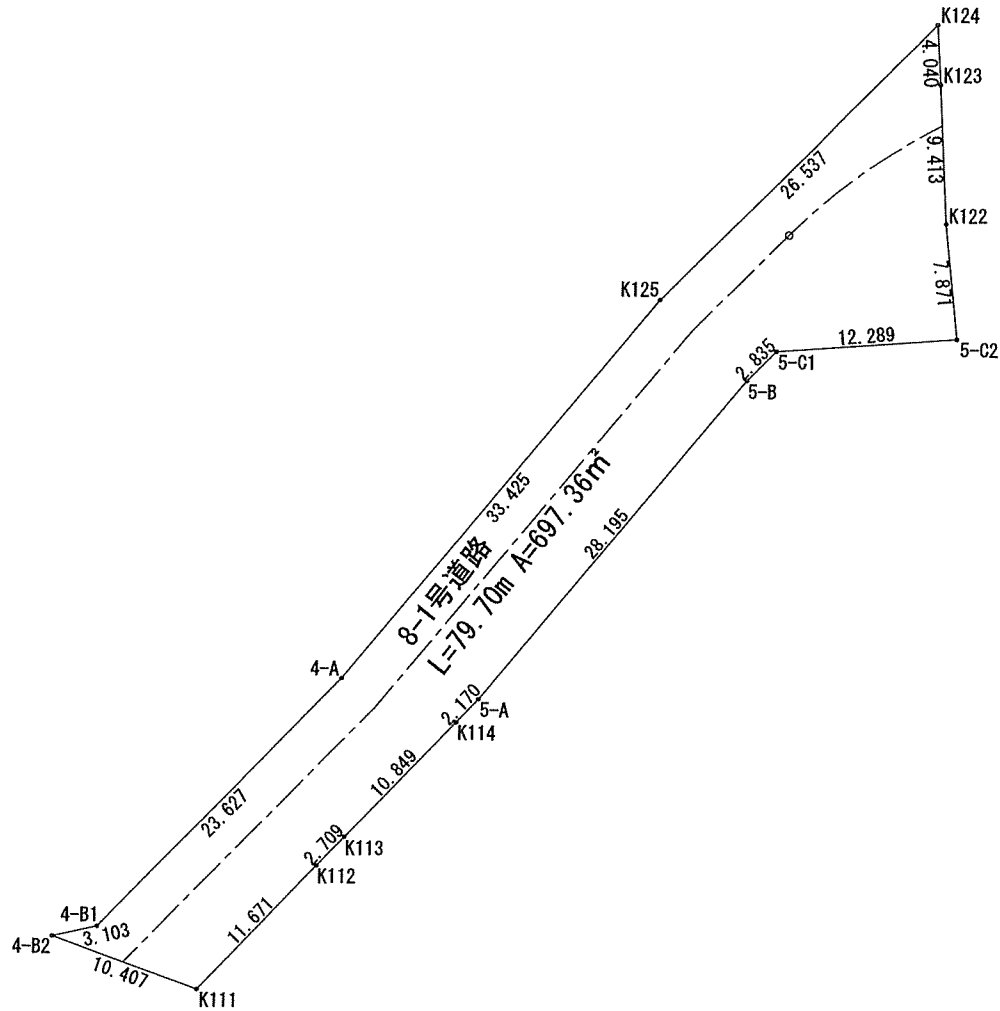

S=1:500

路線番号	8-1号道路
------	--------

面積（座標法）計算書

地番：8-1号道路

測点名	[1] X(i)	[2] X(i+1)-X(i-1)	[3] Y(i)	[4] Y(i+1)-Y(i-1)	[2]*[3]	[1]*[4]	方向角	夾角	距離
5-C2	-126784.819	12.167	-13292.395	7.751	-161728.569965	-982709.132069	334-06-55	88-33-49	7.871
K122	-126777.738	15.749	-13295.831	-7.105	-209396.042419	900755.828490	337-03-29	182-56-34	9.413
K123	-126769.070	12.377	-13299.500	-5.271	-164607.911500	668199.767970	336-38-22	179-34-53	4.040
K124	-126765.361	-20.405	-13301.102	-12.680	271408.986310	1607384.777480	204-40-27	48-02-05	26.537
K125	-126789.475	-55.626	-13312.180	-22.224	740503.324680	2817769.292400	199-28-44	174-48-17	33.425
4-A	-126820.987	-53.085	-13323.326	-20.781	707268.760710	2635466.930847	204-04-00	184-35-16	23.627
4-B1	-126842.560	-23.263	-13332.961	-12.237	310164.671743	1552172.406720	236-59-47	212-55-47	3.103
4-B2	-126844.250	-1.603	-13335.563	7.805	21376.907489	-990019.371250	89-31-16	32-31-29	10.407
K111	-126844.163	10.769	-13325.156	15.109	-143498.604964	-1916488.458767	23-45-29	114-14-13	11.671
K112	-126833.481	13.166	-13320.454	5.784	-175377.097364	-733604.854104	23-32-14	179-46-45	2.709
K113	-126830.997	12.431	-13319.372	5.414	-165573.113332	-686663.017758	23-32-01	179-59-47	10.849
K114	-126821.050	11.936	-13315.040	5.199	-158928.317440	-659342.638950	23-33-08	180-01-07	2.170
5-A	-126819.061	28.567	-13314.173	10.278	-380345.980091	-1303446.308958	19-29-55	175-56-47	28.195
5-B	-126792.483	29.156	-13304.762	10.591	-387913.640872	-1342859.187453	24-35-40	185-05-45	2.835
5-C1	-126789.905	7.664	-13303.582	12.367	-101958.652448	-1568010.755135	65-33-06	220-57-26	12.289
合計					倍面積 1394.720537	-1394.720537			189.141
					面積 697.3602685	697.3602685			
					地積 697.36	697.36			

画地確定原子一覽表

画地面積	128.25 m ²
------	-----------------------

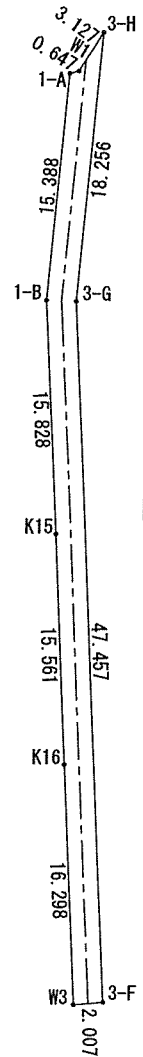

水路1号
L=63.90m A=128.25m²

S=1:500

路線番号	水路1号
------	------

画地確定原子一覽表

画地面積	39.21 m ²
------	----------------------

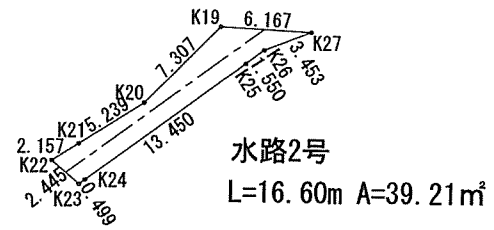
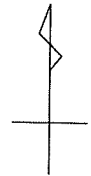

S=1:500

路線番号	水路2号
------	------

画地確定原子一覽表

画地面積

84.05 m²

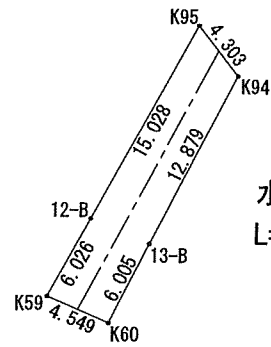
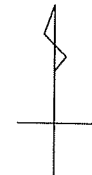

水路3号

L=19.97m A=84.05m²

S=1:500

路線番号

水路3号

画地確定原子一覽表

画地面積	37.74 m ²
------	----------------------

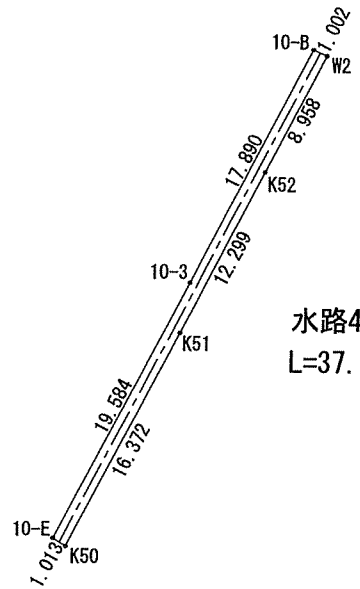

水路4号
L=37.55m A=37.74m²

S=1:500

路線番号	水路4号
------	------

面積 (座標法) 計算書

地番：水路1号

測点名	[1] X(i)	[2] X(i+1)-X(i-1)	[3] Y(i)	[4] Y(i+1)-Y(i-1)	[2]*[3]	[1]*[4]	方向角	夾角	距離
1-A	-126825.673	-15.491	-13483.527	-2.042	208873.316757	258978.024266	185-17-00	110-19-44	15.388
1-B	-126840.996	-31.132	-13484.944	-0.634	419813.276608	80417.191464	177-09-52	171-52-52	15.828
K15	-126856.805	-31.352	-13484.161	1.534	422755.415672	-194598.338870	177-14-02	180-04-10	15.561
K16	-126872.348	-31.822	-13483.410	1.538	429069.073020	-195129.671224	177-13-56	179-59-54	16.298
W3	-126888.627	-16.085	-13482.623	2.785	216867.990955	-353384.826195	84-27-15	87-13-19	2.007
3-F	-126888.433	47.595	-13480.625	-0.310	-641610.346875	39335.414230	357-12-45	92-45-30	47.457
3-G	-126841.032	65.579	-13482.933	-0.618	-884197.263207	78387.757776	5-18-41	188-05-56	18.256
3-H	-126822.854	15.527	-13481.243	0.031	-209323.260061	-3931.508474	212-02-18	26-43-37	3.127
W1	-126825.505	-2.819	-13482.902	-2.284	38008.300738	289669.453420	254-57-16	222-54-58	0.647
合計					倍面積 面積 地積	256.503607 -256.503607 128.2518035 128.2518035 128.25 128.25			134.569

面積 (座標法) 計算書

地番：水路2号

測点名	[1] X(i)	[2] X(i+1)-X(i-1)	[3] Y(i)	[4] Y(i+1)-Y(i-1)	[2]*[3]	[1]*[4]	方向角	夾角	距離
K19	-126891.709	-4.877	-13460.645	-11.322	65647.565665	1436667.929298	224-57-00	132-13-03	7.307
K20	-126896.880	-7.975	-13465.807	-9.587	107389.810825	1216560.388560	237-38-19	192-41-19	5.239
K21	-126899.684	-3.958	-13470.232	-6.247	53315.178256	792742.325948	237-39-04	180-00-45	2.157
K22	-126900.838	-2.744	-13472.054	0.036	36967.316176	-4568.430168	130-33-20	72-54-16	2.445
K23	-126902.428	-1.295	-13470.196	2.261	17443.903820	-286926.389708	53-47-44	103-14-24	0.499
K24	-126902.133	8.243	-13469.793	11.254	-111031.503699	-1428156.604782	53-46-42	179-58-58	13.450
K25	-126894.185	8.880	-13458.942	12.089	-119515.404960	-1534023.802465	53-01-36	179-14-54	1.550
K26	-126893.253	2.182	-13457.704	4.457	-29364.710128	-565563.228621	68-46-40	195-45-04	3.453
K27	-126892.003	1.544	-13454.485	-2.941	-20773.724840	373189.380823	272-43-57	23-57-17	6.167
合計					倍面積 面積 地積	-78.431115 39.2155575 39.21 39.21			42.267

面積 (座標法) 計算書

地番：水路3号

測点名	[1] X(i)	[2] X(i+1)-X(i-1)	[3] Y(i)	[4] Y(i+1)-Y(i-1)	[2]*[3]	[1]*[4]	方向角	夾角	距離
K95	-126927.741	-9.738	-13271.248	-9.943	129235.413024	1262042.528763	209-04-02	66-56-28	15.028
12-B	-126940.876	-18.407	-13278.549	-10.220	244418.251443	1297335.752720	208-58-21	179-54-19	6.026
K59	-126946.148	-7.038	-13281.468	1.273	93474.971784	-161602.446404	112-50-41	83-52-20	4.549
K60	-126947.914	3.593	-13277.276	6.901	-47705.252668	-876067.554514	26-49-01	93-58-20	6.005
13-B	-126942.555	16.776	-13274.567	8.670	-222694.135992	-1100591.951850	27-34-11	180-45-10	12.879
K94	-126931.138	14.814	-13268.606	3.319	-196561.129284	-421284.447022	322-07-34	114-33-23	4.303
合計					倍面積 面積 地積	-168.118307 84.0591535 84.05 84.05			48.790

面積 (座標法) 計算書

地番：水路4号

測点名	[1] X(i)	[2] X(i+1)-X(i-1)	[3] Y(i)	[4] Y(i+1)-Y(i-1)	[2]*[3]	[1]*[4]	方向角	夾角	距離
10-B	-126942.753	-15.442	-13337.545	-9.226	205958.369890	1171173.839178	207-40-15	94-01-19	17.890
10-3	-126958.597	-33.189	-13345.853	-17.402	442935.515217	2209333.504994	207-40-05	179-59-50	19.584
10-E	-126975.942	-17.889	-13354.947	-8.239	238906.646883	1046154.786138	122-28-01	94-47-56	1.013
K50	-126976.486	13.958	-13354.092	8.454	-186396.416136	-1073459.212644	27-39-16	85-11-15	16.372
K51	-126961.984	25.396	-13346.493	13.308	-338947.536228	-1689610.083072	27-39-24	180-00-08	12.299
K52	-126951.090	18.829	-13340.784	9.866	-251193.621936	-1252499.453940	27-38-57	179-59-33	8.958
W2	-126943.155	8.337	-13336.627	3.239	-111187.459299	-411168.879045	293-38-56	85-59-59	1.002
合計					倍面積 面積 地積	-75.498391 37.7491955 37.74 37.74			77.118

画地確定原子一覽表

画地面積	645.57 m ²
------	-----------------------

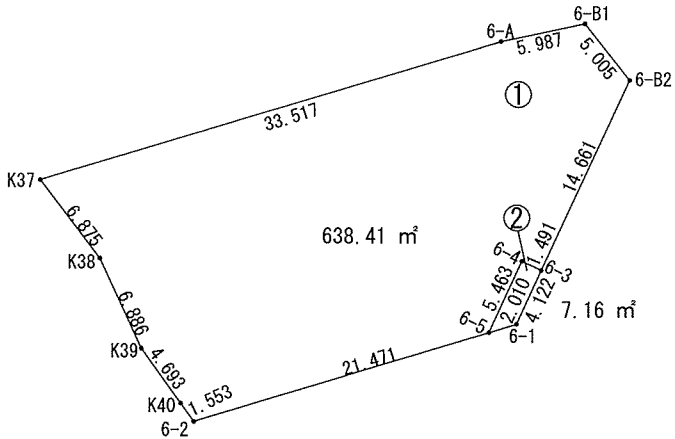
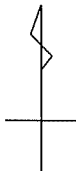

S=1:500

街区番号	公園
------	----

令和 6 年 9 月

公共用地面積 (座標法) 計算書

画地番号 : 公園 6-1

測点名	[1] X (i)	[2] X (i+1)-X (i-1)	[3] Y (i)	[4] Y (i+1)-Y (i-1)	[2]*[3]	[1]*[4]	方向角	夾角	距離
6-B2	-126855.352	17.212	-13338.898	3.047	-229589.112376	-386528.257544	321-24-29	116-31-28	5.005
6-B1	-126851.440	2.670	-13342.020	-8.979	-35623.193400	1138999.079760	258-01-39	116-37-10	5.987
6-A	-126852.682	-10.936	-13347.877	-37.942	145972.382872	4813044.460444	253-11-19	175-09-40	33.517
K37	-126862.376	-15.180	-13379.962	-27.941	203107.823160	3544661.647816	142-56-00	69-44-41	6.875
K38	-126867.862	-11.738	-13375.818	7.031	157005.351684	-892007.937722	155-12-50	192-16-50	6.886
K39	-126874.114	-10.060	-13372.931	5.630	134531.685860	-714301.261820	144-14-02	169-01-12	4.693
K40	-126877.922	-5.068	-13370.188	3.651	67760.112784	-463231.293222	144-13-20	179-59-18	1.553
6-2	-126879.182	4.949	-13369.280	21.462	-66164.566720	-2723081.004084	73-11-29	108-58-09	21.471
6-5	-126872.973	11.161	-13348.726	22.862	-148985.130886	-2900569.908726	24-59-20	131-47-51	5.463
6-4	-126868.021	4.321	-13346.418	3.659	-57669.872178	-464210.088839	115-02-08	270-02-48	1.491
6-3	-126868.652	12.669	-13345.067	7.520	-169068.653823	-954052.263040	24-53-01	89-50-53	14.661
合計				倍面積	1276.826977	-1276.826977			107.602
				面積	638.4134885	638.4134885			
				地積	638.41	638.41			

公共用地面積 (座標法) 計算書

画地番号 : 6-2

測点名	[1] X (i)	[2] X (i+1)-X (i-1)	[3] Y (i)	[4] Y (i+1)-Y (i-1)	[2]*[3]	[1]*[4]	方向角	夾角	距離
6-1	-126872.391	4.321	-13346.802	3.659	-57671.531442	-464226.078669	24-53-33	131-43-22	4.122
6-3	-126868.652	4.370	-13345.067	0.384	-58317.942790	-48717.562368	295-02-08	90-08-35	1.491
6-4	-126868.021	-4.321	-13346.418	-3.659	57669.872178	464210.088839	204-59-20	89-57-12	5.463
6-5	-126872.973	-4.370	-13348.726	-0.384	58333.932620	48719.221632	73-10-11	48-10-51	2.010
合計				倍面積	14.330566	-14.330566			13.086
				面積	7.1652830	7.1652830			
				地積	7.16	7.16			

画地確定原子一覽表

画地面積	430.15 m ²
------	-----------------------

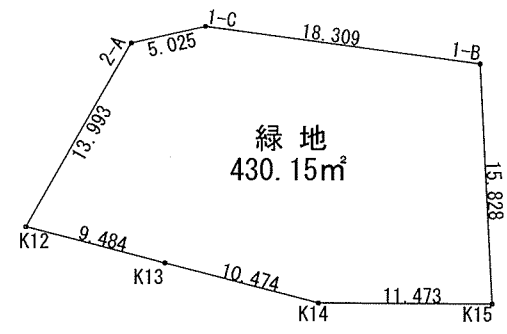
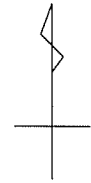

S=1:500

路線番号	緑地
------	----

面積（座標法）計算書

地番：緑地

測点名	[1] X(i)	[2] X(i+1)-X(i-1)	[3] Y(i)	[4] Y(i+1)-Y(i-1)	[2]*[3]	[1]*[4]	方向角	夾角	距離
1-C	-126838.550	1.330	-13503.089	-23.045	-17959.108370	2922994.384750	257-10-10	159-29-32	5.025
2-A	-126839.666	-13.247	-13507.989	-11.874	178940.330283	1506094.194084	209-53-39	132-43-29	13.993
K12	-126851.797	-14.487	-13514.963	2.213	195791.268981	-280723.026761	104-23-01	74-29-22	9.484
K13	-126854.153	-4.972	-13505.776	19.329	67150.718272	-2451963.923337	104-27-48	180-04-47	10.474
K14	-126856.769	-2.652	-13495.634	21.615	35790.421368	-2742009.061935	90-10-47	165-42-59	11.473
K15	-126856.805	15.773	-13484.161	10.690	-212685.671453	-1356099.245450	357-09-52	86-59-05	15.828
1-B	-126840.996	18.255	-13484.944	-18.928	-246167.652720	2400846.372288	277-40-38	100-30-46	18.309
合計				倍面積	860.306361	-860.306361			84.586
				面積	430.1531805	430.1531805			
				地積	430.15	430.15			