

# 画地確定原子一覽表

画地面積

768.24 m<sup>2</sup>

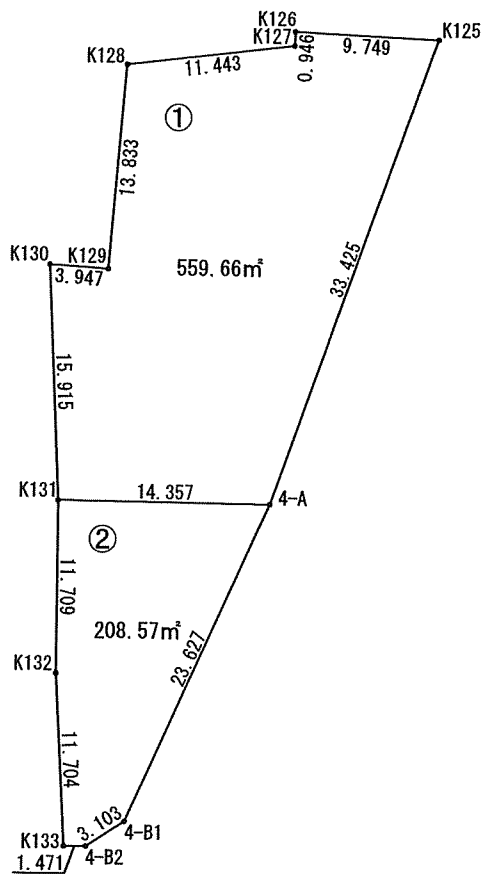

S=1:500

街区番号

4

令和6年9月

## 面積 ( 座標法 ) 計算書

地番： 4街区

測点名	[1] X(i)	[2] X(i+1)-X(i-1)	[3] Y(i)	[4] Y(i+1)-Y(i-1)	[2]*[3]	[1]*[4]	方向角	夾角	距離
K125	-126789.475	31.900	-13312.180	1.405	-424658.542000	-178139.212375	272-16-52	72-48-08	9.749
K126	-126789.087	-0.557	-13321.921	-9.782	7420.309997	1240250.849034	182-29-03	90-12-11	0.946
K127	-126790.032	-2.348	-13321.962	-11.398	31279.966776	1445152.784736	262-57-27	260-28-24	11.443
K128	-126791.435	-15.190	-13333.319	-12.485	202533.115610	1582991.065975	184-40-38	101-43-11	13.833
K129	-126805.222	-13.525	-13334.447	-5.066	180348.395675	642395.254652	273-48-23	269-07-45	3.947
K130	-126804.960	-15.637	-13338.385	-3.235	208572.326245	410214.045600	177-28-06	83-39-43	15.915
K131	-126820.859	-27.608	-13337.682	0.713	368226.724656	-90423.272467	179-57-04	182-28-58	11.709
K132	-126832.568	-23.396	-13337.672	0.648	312048.174112	-82187.504064	176-52-31	176-55-27	11.704
K133	-126844.255	-11.682	-13337.034	2.109	155803.231188	-267514.533795	89-48-19	92-55-48	1.471
4-B2	-126844.250	1.695	-13335.563	4.073	-22603.779285	-516636.630250	56-59-47	147-11-28	3.103
4-B1	-126842.560	23.263	-13332.961	12.237	-310164.671743	-1552172.406720	24-04-00	147-04-13	23.627
4-A	-126820.987	53.085	-13323.326	20.781	-707268.760710	-2635466.930847	19-28-44	175-24-44	33.425
合計					倍面積 面積 地積	1536.490521 768.2452605 768.24			140.872

## 面積 ( 座標法 ) 計算書

地番： 4-1

測点名	[1] X(i)	[2] X(i+1)-X(i-1)	[3] Y(i)	[4] Y(i+1)-Y(i-1)	[2]*[3]	[1]*[4]	方向角	夾角	距離
K125	-126789.475	31.900	-13312.180	1.405	-424658.542000	-178139.212375	272-16-52	72-48-08	9.749
K126	-126789.087	-0.557	-13321.921	-9.782	7420.309997	1240250.849034	182-29-03	90-12-11	0.946
K127	-126790.032	-2.348	-13321.962	-11.398	31279.966776	1445152.784736	262-57-27	260-28-24	11.443
K128	-126791.435	-15.190	-13333.319	-12.485	202533.115610	1582991.065975	184-40-38	101-43-11	13.833
K129	-126805.222	-13.525	-13334.447	-5.066	180348.395675	642395.254652	273-48-23	269-07-45	3.947
K130	-126804.960	-15.637	-13338.385	-3.235	208572.326245	410214.045600	177-28-06	83-39-43	15.915
K131	-126820.859	-16.027	-13337.682	15.059	213763.029414	-1909795.315681	90-30-39	93-02-33	14.357
4-A	-126820.987	31.384	-13323.326	25.502	-418139.263184	-3234188.810474	19-28-44	108-58-05	33.425
合計					倍面積 面積 地積	1119.338533 559.6692665 559.66			103.615

## 面積 ( 座標法 ) 計算書

地番： 4-2

測点名	[1] X(i)	[2] X(i+1)-X(i-1)	[3] Y(i)	[4] Y(i+1)-Y(i-1)	[2]*[3]	[1]*[4]	方向角	夾角	距離
4-A	-126820.987	21.701	-13323.326	-4.721	-289129.497526	598721.879627	270-30-39	66-26-39	14.357
K131	-126820.859	-11.581	-13337.682	-14.346	154463.695242	1819372.043214	179-57-04	89-26-25	11.709
K132	-126832.568	-23.396	-13337.672	0.648	312048.174112	-82187.504064	176-52-31	176-55-27	11.704
K133	-126844.255	-11.682	-13337.034	2.109	155803.231188	-267514.533795	89-48-19	92-55-48	1.471
4-B2	-126844.250	1.695	-13335.563	4.073	-22603.779285	-516636.630250	56-59-47	147-11-28	3.103
4-B1	-126842.560	23.263	-13332.961	12.237	-310164.671743	-1552172.406720	24-04-00	147-04-13	23.627
合計					倍面積 面積 地積	417.151988 208.5759940 208.57			65.971