

西尾西山土地区画整理事業 公共用地出来形確認測量図 縮尺 1:1000

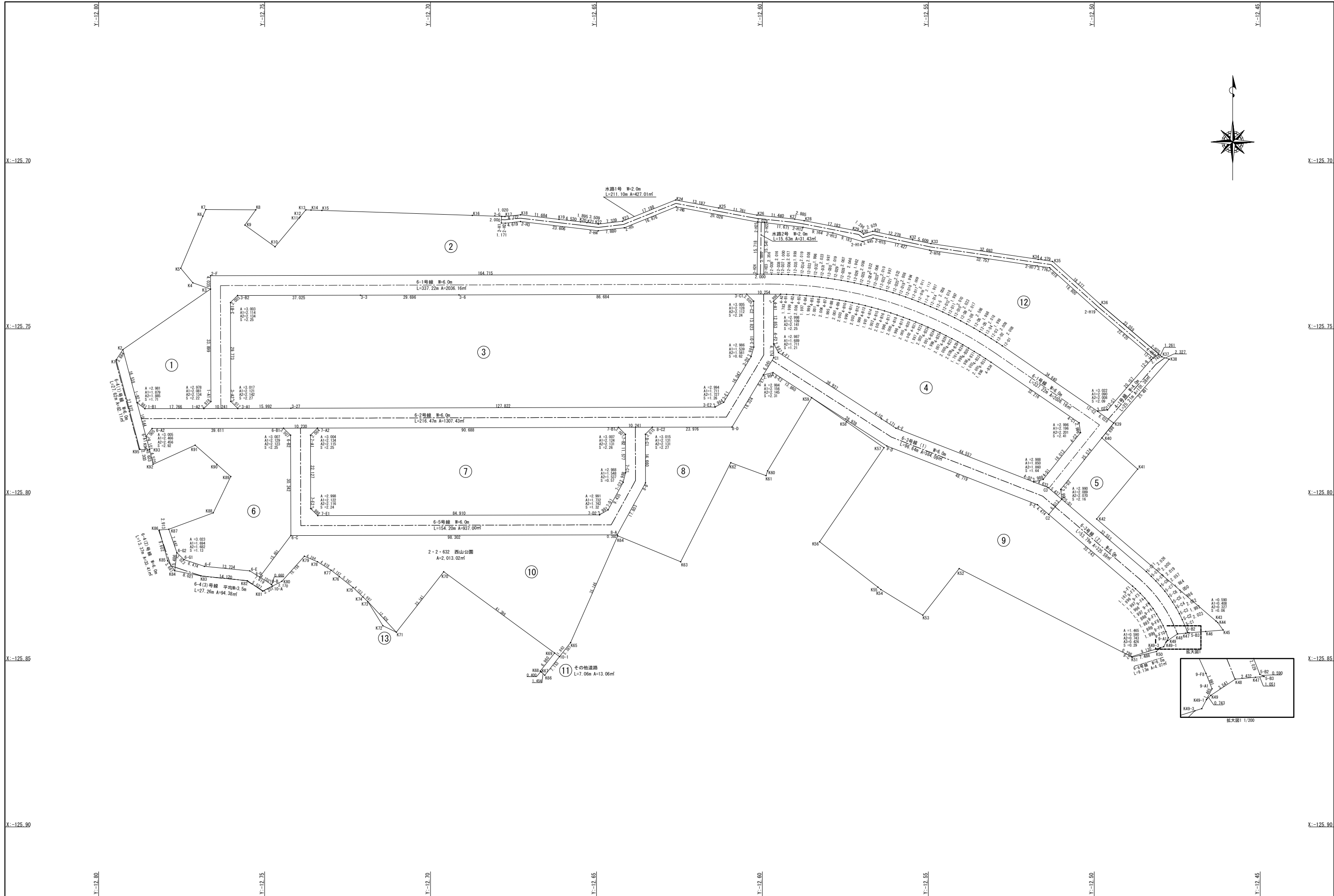

公共用地面積（座標法）計算書

画地番号： 4-1号

測点名	[1] X(i)	[2] X(i+1)-X(i-1)	[3] Y(i)	[4] Y(i+1)-Y(i-1)	[2]*[3]	[1]*[4]	方向角	夾角	距離	
12-B	-125759.210	-16.848	-12482.777	-15.432	210309.826896	1940716.128720	220-59-42	167-29-07	20.157	
12-C1	-125774.424	-15.611	-12496.000	-16.219	195075.056000	2039935.382856	262-27-06	221-27-24	3.022	
12-C2	-125774.821	-3.939	-12498.996	1.881	49233.545244	-236582.438301	125-59-23	43-32-17	6.028	
K39	-125778.363	15.699	-12494.119	21.598	-196145.174181	-2716561.084074	40-59-30	95-00-07	25.491	
K38	-125759.122	19.969	-12477.398	14.511	-249161.160662	-1824890.619342	288-13-57	67-14-27	2.327	
K37	-125758.394	1.546	-12479.608	-3.170	-19293.473968	398654.108980	310-26-02	202-12-05	1.261	
2-H20	-125757.576	-0.816	-12480.568	-3.169	10184.143488	398525.758344	233-30-35	103-04-33	2.748	
合計					倍面積 面積 坪数	202.762817 101.3814085 30.66			-202.762817 101.3814085 30.66	61.034

公共用地面積（座標法）計算書

画地番号： 6-1号

測点名	[1] X(i)	[2] X(i+1)-X(i-1)	[3] Y(i)	[4] Y(i+1)-Y(i-1)	[2]*[3]	[1]*[4]	方向角	夾角	距離
1-A1	-125771.900	-35.983	-12766.185	-2.026	459365.634855	254813.869400	225-35-06	225-45-21	2.978
1-A2	-125773.984	-2.070	-12768.312	8.114	26430.405840	-1020530.106176	89-55-18	44-20-12	10.241
3-A1	-125773.970	2.153	-12758.071	8.114	-27468.126863	-1020529.992580	315-09-40	45-14-22	3.017
3-A2	-125771.831	31.912	-12760.198	-2.211	-407203.438576	278081.518341	359-50-18	224-40-38	29.773
3-B1	-125742.058	31.892	-12760.282	2.044	-406950.913544	-257016.766552	45-07-17	225-16-59	3.003
3-B2	-125739.939	2.207	-12758.154	39.153	-28157.245878	-4923095.831667	89-51-50	224-44-33	37.025
3-3	-125739.851	0.180	-12721.129	66.721	-2289.803220	-8389488.598571	89-49-21	179-57-31	29.696
3-6	-125739.759	0.326	-12691.433	116.380	-4137.407158	-14633593.152420	89-50-43	180-01-22	86.684
3-C1	-125739.525	0.216	-12604.749	96.938	-2722.625784	-12188938.074450	90-06-02	180-15-19	10.254
4-A2	-125739.543	-0.074	-12594.495	12.036	931.992630	-1513401.139548	91-48-00	181-41-58	1.783
4-B1	-125739.599	-0.149	-12592.713	3.779	1876.314237	-475169.944621	92-39-59	180-51-59	1.999
4-B2	-125739.692	-0.226	-12590.716	3.999	2845.501816	-502833.028308	93-48-03	181-08-04	2.006
4-B3	-125739.825	-0.301	-12588.714	3.992	3789.202914	-501953.381400	94-49-32	181-01-29	1.997
4-B4	-125739.993	-0.363	-12586.724	3.979	4568.980812	-500319.432147	95-35-58	180-46-26	1.999
4-B5	-125740.188	-0.430	-12584.735	3.976	5411.436050	-499942.987488	96-44-42	181-08-44	2.001
4-B6	-125740.423	-0.500	-12582.748	3.973	6291.374000	-499566.700579	97-36-01	180-51-19	2.004
4-B7	-125740.688	-0.569	-12580.762	3.958	7158.453578	-497681.643104	98-45-49	181-09-48	1.995
4-B8	-125740.992	-0.635	-12578.790	3.945	7987.531650	-496048.213440	99-31-25	180-45-36	2.001
4-B9	-125741.323	-0.697	-12576.817	3.942	8766.041449	-495672.295266	100-31-48	181-00-23	2.003
4-B10	-125741.689	-0.766	-12574.848	3.928	9632.333568	-493913.354392	101-32-25	181-00-37	1.999
4-B11	-125742.089	-0.839	-12572.889	3.913	10548.653871	-492028.794257	102-39-44	181-07-19	2.003
4-B12	-125742.528	-0.903	-12570.935	3.898	11351.554305	-490144.374144	103-25-28	180-45-44	1.999
4-B13	-125742.992	-0.966	-12568.991	3.877	12141.645306	-487505.579984	104-33-29	181-08-01	1.997
4-B14	-125743.494	-1.034	-12567.058	3.863	12994.337972	-485747.117322	105-24-39	180-51-10	2.002
4-B15	-125744.026	-1.087	-12565.128	3.852	13658.294136	-484365.988152	106-06-24	180-41-45	2.001
4-B16	-125744.581	-1.164	-12563.206	3.823	14623.571784	-480721.533163	107-45-48	181-39-24	1.996
4-B17	-125745.190	-1.240	-12561.305	3.799	15576.018200	-477705.976810	108-23-23	180-37-35	2.000
4-B18	-125745.821	-1.297	-12559.407	3.782	16289.550879	-475570.695022	109-28-07	181-04-44	1.998
4-B19	-125746.487	-1.371	-12557.523	3.761	17216.364033	-472932.537607	110-35-10	181-07-03	2.005
4-B20	-125747.192	-1.435	-12555.646	3.741	18017.352010	-470420.245272	111-23-13	180-48-03	2.002
4-B21	-125747.922	-1.488	-12553.782	3.712	18680.027616	-466776.286464	112-18-08	180-54-55	1.997
4-B22	-125748.680	-1.553	-12551.934	3.685	19493.153502	-463383.885800	113-24-06	181-05-58	2.002
4-B23	-125749.475	-1.617	-12550.097	3.661	20293.506849	-460368.827975	114-15-33	180-51-27	2.001
4-B24	-125750.297	-1.679	-12548.273	3.630	21068.550367	-456473.578110	115-23-09	181-07-36	1.999
4-B25	-125751.154	-1.739	-12546.467	3.602	21818.306113	-452955.656708	116-09-19	180-46-10	2.001
4-B26	-125752.036	-1.800	-12544.671	3.573	22580.407800	-449312.024628	117-19-15	181-09-56	2.000
4-B27	-125752.954	-1.867	-12542.894	3.548	23417.583098	-446171.480792	118-11-06	180-51-51	2.009
4-B28	-125753.903	-1.812	-12541.123	3.506	22724.514876	-415742.403318	119-20-43	181-09-37	1.761
4-B29	-125754.766	-1.863	-12539.588	3.265	23361.252444	-410589.310990	120-01-46	180-41-03	1.998
4-B30	-125755.766	-2.027	-12537.858	3.444	25414.238166	-433102.858104	120-55-46	180-54-00	1.998
4-B31	-125756.793	-2.086	-12536.144	3.414	26150.396384	-429333.691302	121-55-14	180-59-28	2.003
4-B32	-125757.852	-2.146	-12534.444	3.380	26898.916824	-425061.539760	122-54-14	180-59-00	2.001
4-B33	-125758.939	-2.196	-12532.764	3.339	27521.949744	-419909.097321	123-45-42	180-51-28	1.996
4-B34	-125760.048	-19.349	-12531.105	28.214	242464.350645	-3548193.994272	124-29-03	180-43-21	32.216
4-C1	-125778.288	-21.204	-12504.550	26.992	265146.478200	-3395007.549696	171-36-47	227-07-44	2.996
4-C2	-125781.252	-17.039	-12504.113	-10.803	213057.581407	1358814.865356	218-36-36	226-59-49	18.012
4-D1	-125795.327	-14.845	-12515.353	-14.127	185790.415285	1777110.584529	255-03-58	216-27-22	2.988
4-D2	-125796.097	-2.453	-12518.240	1.429	30707.242720	-179762.622613	111-18-11	36-14-13	4.633
C3	-125797.780	-5.217	-12513.924	8.448	65285.141508	-1062739.645440	130-32-22	199-14-11	5.437
5-D1	-125801.314	-0.559	-12509.792	3.836	6992.973728	-482573.840504	354-19-05	43-46-43	2.990
5-D2	-125798.339	22.951	-12510.088	15.673	-287119.029688	-1971637.367147	38-38-21	224-19-16	25.574
K39	-125778.363	23.518	-12494.119	11.092	-293836.690642	-1395133.602396	305-59-23	87-21-02	6.028
12-C2	-125774.821	23.268	-12498.996	-33.595	-290826.638928	4225405.111495	304-29-05	178-29-42	34.840
12-D1	-125755.095	20.844	-12527.714	-30.386	-261127.670616	3821194.316670	303-49-57	179-20-52	2.008
12-D2	-125753.977	2.208	-12529.382	-3.355	-27664.875456	421904.592835	302-52-02	179-02-05	2.008
12-D3	-125752.887	2.146	-12531.069	-3.384	-26891.674074	425547.769608	301-53-35	179-01-33	1.999
12-D4	-125751.831	2.096	-12532.766	-3.426	-26268.677536	430825.773006	301-01-37	179-08-02	2.018
12-D5	-125750.791	2.050	-12534.495	-3.453	-25695.714750	434217.481323	300-21-50	179-20-13	1.998
12-D6	-125749.781	2.273	-12536.219	-3.958	-28494.825787	497717.633198	299-28-54	179-07-04	2.566
12-D8	-125748.518	2.215	-12538.453	-4.012	-27772.673395	504503.054216	298-09-58	178-41-04	2.017
12-D9	-125747.566	1.872	-12540.231	-3.580	-23475.312432	450176.286280	297-02-47	178-52-49	2.023
12-D10	-125746.646	1.810	-12542.033	-3.604	-22701.079730	453190.912184	296-17-04	179-14-17	2.010
12-D11	-125745.756	1.744	-12543.835	-3.607	-21876.448240	453564.941892	295-19-13	179-02-09	1.997
12-D12	-125744.902	1.685	-12545.640	-3.644	-21139.403400	458214.422888	294-19-01	178-59-48	2.018
12-5	-125744.071	1.630	-12547.479	-3.681	-20452.390770	462863.925351	293-26-59	179-07-58	2.008
12-D14	-125743.272	1.530	-12549.321	-3.603	-19200.461130	453053.009016	292-32-37	179-05-38	1.907
12-6	-125742.541	1.509	-12551.082	-3.724	-18939.582738	468265.222684	291-37-12	179-04-35	2.112
12-D16	-125741.763	1.488	-12553.045	-3.845	-18678.930960	483477.078735	290-40-10	179-02-58	2.011
12-D17	-125741.053	1.385	-12554.927	-3.774	-17388.573895	474546.734022	289-38-05	178-57-55	2.009

画地番号： 6-1号

测点名	[1] X(i)	[2] X(i+1)-X(i-1)	[3] Y(i)	[4] Y(i+1)-Y(i-1)	[2]*[3]	[1]*[4]	方向角	夹角	距離
12-D18	-125740.378	1.315	-12556.819	-3.781	-16512.216985	475424.369218	288-43-00	179-04-55	1.994
12-D19	-125739.738	1.254	-12558.708	-3.801	-15748.619832	477936.744138	287-48-12	179-05-12	2.008
12-D20	-125739.124	1.200	-12560.620	-3.847	-15072.744000	483718.410028	286-50-55	179-02-43	2.022
12-D21	-125738.538	1.133	-12562.555	-3.856	-14233.374815	484847.802528	285-53-39	179-02-44	1.997
12-D22	-125737.991	1.062	-12564.476	-3.864	-13343.473512	485851.597224	284-50-42	178-57-03	2.010
12-D23	-125737.476	1.001	-12566.419	-3.889	-12578.985419	488993.044164	284-01-21	179-10-39	2.006
12-D24	-125736.990	0.951	-12568.365	-3.914	-11952.515115	492134.578860	283-17-39	179-16-18	2.022
12-D25	-125736.525	0.887	-12570.333	-3.931	-11149.885371	494270.279775	282-07-57	178-50-18	2.008
12-D26	-125736.103	0.808	-12572.296	-3.887	-10158.415168	488736.232361	281-20-39	179-12-42	1.962
12-8	-125735.717	0.753	-12574.220	-3.937	-9468.387660	495021.517829	280-19-57	178-59-18	2.046
12-D28	-125735.350	0.692	-12576.233	-3.994	-8702.753236	502186.987900	279-19-01	178-59-04	2.007
12-D29	-125735.025	0.629	-12578.214	-3.977	-7911.696606	500048.194425	278-39-35	179-20-34	2.019
12-D30	-125734.721	0.573	-12580.210	-3.975	-7208.460330	499795.515975	277-44-26	179-04-51	1.997
12-D31	-125734.452	0.510	-12582.189	-3.988	-6416.916390	501428.994576	276-50-26	179-06-00	2.023
12-D32	-125734.211	0.433	-12584.198	-3.996	-5448.957734	502433.907156	275-31-09	178-40-43	1.996
12-D33	-125734.019	0.355	-12586.185	-3.988	-4468.095675	501427.267772	274-39-25	179-08-16	2.008
12-D34	-125733.856	0.299	-12588.186	-4.015	-3763.867614	504821.431840	273-51-47	179-12-22	2.019
12-D35	-125733.720	0.239	-12590.200	-4.010	-3009.057800	504192.217200	272-57-14	179-05-27	1.999
12-D36	-125733.617	0.170	-12592.196	-4.012	-2140.673320	504443.271404	271-54-13	178-56-59	2.017
12-D37	-125733.550	0.091	-12594.212	-3.016	-1146.073292	379212.386800	271-22-29	179-28-16	1.000
12-D38	-125733.526	0.042	-12595.212	-3.016	-528.998904	379212.314416	270-30-42	179-08-13	2.016
12-D39	-125733.508	0.010	-12597.228	-4.372	-125.972280	549706.896976	269-48-20	179-17-38	2.356
2-H23	-125733.516	-0.017	-12599.584	-4.356	214.192928	547695.195696	269-44-32	179-56-12	2.000
2-H24	-125733.525	-0.450	-12601.584	-166.714	5670.712800	20961538.886850	269-50-48	180-06-16	164.715
2-F	-125733.966	-4.476	-12766.298	-164.702	57141.949848	20708635.668132	179-49-47	89-58-59	4.035
K3	-125738.001	-37.934	-12766.286	0.113	484276.293124	-14208.394113	179-49-45	179-59-58	33.899
合計				倍面積	4072.325623	-4072.325623			696.831
				面積	2036.1628115	2036.1628115			
				坪数	615.93	615.93			

公共用地面積(座標法)計算書

画地番号： 6-2号

測点名	[1] X(i)	[2] X(i+1)-X(i-1)	[3] Y(i)	[4] Y(i+1)-Y(i-1)	[2]*[3]	[1]*[4]	方向角	夾角	距離
1-B2	-125772.211	-8.372	-12788.441	0.346	107064.828052	-43517.185006	165-06-44	37-32-20	10.544
6-A1	-125782.401	-7.800	-12785.732	4.531	99728.709600	-569920.058931	37-19-11	52-12-27	3.005
6-A2	-125780.011	2.501	-12783.910	41.433	-31972.558910	-5211443.195763	89-50-22	232-31-11	39.611
6-B1	-125779.900	0.137	-12744.299	49.841	-1745.968963	-6268995.995900	89-51-16	180-00-54	10.230
7-A2	-125779.874	0.266	-12734.069	100.918	-3387.262354	-12693453.324332	89-50-54	179-59-38	90.688
7-B1	-125779.634	0.279	-12643.381	100.929	-3527.503299	-12694812.679986	89-46-55	179-56-01	10.241
8-C2	-125779.595	0.073	-12633.140	34.217	-922.219220	-4303800.402115	89-55-07	180-08-12	23.976
8-D	-125779.561	15.729	-12609.164	33.433	-198329.540556	-4205188.062913	31-04-16	121-09-09	18.324
8-E1	-125763.866	20.886	-12599.707	12.585	-263157.480402	-1582738.253610	31-04-21	180-00-05	6.061
C1	-125758.675	9.365	-12596.579	3.115	-117966.962335	-391738.272625	359-49-18	148-44-57	4.174
4-F2	-125754.501	17.027	-12596.592	-0.051	-214482.171984	6413.479551	359-49-50	180-00-32	12.853
4-A1	-125741.648	14.958	-12596.630	2.097	-188420.391540	-263680.235856	45-24-19	225-34-29	2.998
4-A2	-125739.543	2.123	-12594.495	-8.119	-26738.112885	1020879.349617	270-06-02	44-41-43	10.254
3-C1	-125739.525	-2.098	-12604.749	-8.121	26444.763402	1021130.682525	134-46-15	44-40-13	3.005
3-C2	-125741.641	-15.939	-12602.616	2.169	200873.096424	-272733.619329	179-51-03	225-04-48	13.823
3-D1	-125755.464	-16.700	-12602.580	-0.764	210463.086000	96077.174496	195-32-22	195-41-19	2.986
3-D2	-125758.341	-16.629	-12603.380	-9.069	209581.606020	1140502.394529	211-01-06	195-28-44	16.047
3-E1	-125772.093	-15.223	-12611.649	-10.877	191987.132727	1368023.055561	240-34-32	209-33-26	2.994
3-E2	-125773.564	-1.812	-12614.257	-130.430	22857.033684	16404645.952520	269-50-50	209-16-18	127.822
3-27	-125773.905	-0.406	-12742.079	-143.814	5173.284074	18088048.373670	269-46-02	179-55-12	15.992
3-A1	-125773.970	-0.079	-12758.071	-26.233	1007.887609	3299428.555010	269-55-18	180-09-16	10.241
1-A2	-125773.984	-0.059	-12768.312	-28.007	753.330408	3522551.969888	269-51-18	179-56-00	17.766
1-B1	-125774.029	1.773	-12786.078	-20.129	-22669.716294	2531705.429741	307-34-24	217-43-06	2.981
合計				倍面積	2614.869258	-2614.869258			456.616
				面積	1307.4346290	1307.4346290			
				坪数	395.49	395.49			

公共用地面積（座標法）計算書

画地番号： 6-3号(1)

測点名	[1] X(i)	[2] X(i+1)-X(i-1)	[3] Y(i)	[4] Y(i+1)-Y(i-1)	[2]*[3]	[1]*[4]	方向角	夾角	距離
4-F1	-125757.125	22.598	-12595.165	-32.498	-284625.538670	4086855.048250	331-27-41	208-43-35	2.987
4-F2	-125754.501	-1.550	-12596.592	-1.414	19524.717600	177816.864414	179-49-18	28-21-37	4.174
C1	-125758.675	-9.365	-12596.579	-3.115	117966.962335	391738.272625	211-04-21	211-15-03	6.061
8-E1	-125763.866	-4.508	-12599.707	-0.213	56799.479156	26787.703458	76-48-47	45-44-26	2.994
8-E2	-125763.183	-6.837	-12596.792	14.557	86124.266904	-1830734.654931	122-51-36	226-02-49	13.860
K59	-125770.703	-22.082	-12585.150	34.306	277905.282300	-4314689.737118	122-43-17	179-51-41	26.939
9-D	-125785.265	-32.273	-12562.486	68.050	405429.110678	-8559687.283250	111-19-02	168-35-45	48.719
9-E	-125802.976	-20.619	-12517.100	48.786	258090.084900	-6137423.987136	130-32-25	199-13-23	4.474
C2	-125805.884	1.662	-12513.700	7.308	-20797.769400	-919389.400272	40-32-07	89-59-42	6.013
5-D1	-125801.314	8.104	-12509.792	-0.224	-101379.354368	28179.494336	310-32-22	90-00-15	5.437
C3	-125797.780	5.217	-12513.924	-8.448	-65285.141508	1062739.645440	291-18-11	160-45-49	4.633
4-D2	-125796.097	17.872	-12518.240	-45.828	-223725.985280	5764983.533316	291-18-18	180-00-07	44.557
4-E	-125779.908	18.998	-12559.752	-45.854	-238610.168496	5767511.901432	302-54-01	191-35-43	5.171
4-10	-125777.099	22.783	-12564.094	-35.413	-286247.753602	4454144.406887	302-44-06	179-50-05	36.937
合計					倍面積 1168.192549	-1168.192549			212.956
					面積 584.0962745	584.0962745			
					坪数 176.68	176.68			

公共用地面積(座標法)計算書

画地番号：6-3号(2)

測点名	[1] X(i)	[2] X(i+1)-X(i-1)	[3] Y(i)	[4] Y(i+1)-Y(i-1)	[2]*[3]	[1]*[4]	方向角	夾角	距離
9-F1	-125827.491	-22.380	-12488.437	26.129	279491.220060	-3287746.512339	131-45-09	181-12-46	1.161
9-F2	-125828.264	-2.153	-12487.571	2.308	26885.740363	-290411.633312	133-44-29	181-59-20	1.996
9-F3	-125829.644	-2.839	-12486.129	2.806	35448.120231	-353077.981064	136-55-39	183-11-10	1.997
9-F4	-125831.103	-2.988	-12484.765	2.647	37304.477820	-333074.929641	139-59-59	183-04-20	1.996
9-F5	-125832.632	-3.124	-12483.482	2.485	38998.397768	-312694.090520	142-59-53	182-59-54	1.997
9-F6	-125834.227	-3.261	-12482.280	2.305	40704.715080	-290047.893235	146-29-34	183-29-41	1.998
9-F7	-125835.893	-3.385	-12481.177	2.115	42248.784145	-266142.913695	149-30-51	183-01-17	1.995
9-F8	-125837.612	-3.491	-12480.165	1.937	43568.256015	-243747.454444	152-26-06	182-55-15	1.999
9-F9	-125839.384	-3.592	-12479.240	1.752	44825.430080	-220470.600768	155-33-47	183-07-41	1.999
9-F10	-125841.204	-3.672	-12478.413	1.559	45820.732536	-196186.437036	158-26-01	182-52-14	1.991
9-A1	-125843.056	-3.154	-12477.681	0.060	39354.605874	-7550.583360	207-17-58	228-51-57	1.465
K49-1	-125844.358	-0.785	-12478.353	-0.138	9795.507105	17366.521404	45-55-36	18-37-38	0.743
K49	-125843.841	2.477	-12477.819	3.483	-30907.557663	-438314.098203	56-23-27	190-27-51	3.541
K48	-125841.881	2.168	-12474.870	5.372	-27045.518160	-676022.584732	85-05-37	208-42-10	2.432
K47	-125841.673	0.300	-12472.447	3.470	-3741.734100	-436670.605310	84-58-42	179-53-05	1.051
5-B3	-125841.581	0.361	-12471.400	0.522	-4502.175400	-65689.305282	297-07-47	32-09-05	0.590
5-B2	-125841.312	2.159	-12471.925	-1.262	-26926.886075	158811.735744	338-41-49	221-34-02	2.029
5-C1	-125839.422	3.747	-12472.662	-1.539	-46735.064514	193666.870458	336-38-29	177-56-40	2.023
5-C2	-125837.565	3.647	-12473.464	-1.679	-45490.723208	211281.271635	333-53-52	177-15-23	1.993
5-C3	-125835.775	3.586	-12474.341	-1.869	-44732.986826	235187.063475	331-05-11	177-11-19	2.052
5-C4	-125833.979	3.498	-12475.333	-2.035	-43638.714834	256072.147265	328-29-59	177-24-48	1.996
5-C5	-125832.277	3.402	-12476.376	-2.188	-42444.631152	275321.022076	326-02-19	177-32-20	2.050
5-C6	-125830.577	3.281	-12477.521	-2.343	-40938.746401	294821.041911	322-50-49	176-48-30	1.984
5-C7	-125828.996	3.163	-12478.719	-2.512	-39470.188197	316082.437952	320-17-14	177-26-25	2.057
5-C8	-125827.414	3.069	-12480.033	-2.679	-38301.221277	337091.642106	317-26-58	177-09-44	2.019
5-C9	-125825.927	2.898	-12481.398	-2.790	-36171.091404	351054.336330	314-43-02	177-16-04	2.005
5-C10	-125824.516	2.805	-12482.823	-2.895	-35014.318515	364261.973820	313-28-48	178-45-46	2.026
5-C11	-125823.122	23.202	-12484.293	-26.969	-289660.566186	3393323.777218	310-32-19	177-03-31	33.553
5-D1	-125801.314	17.238	-12509.792	-29.407	-215643.794496	3699439.240798	220-32-07	89-59-48	6.013
C2	-125805.884	-26.177	-12513.700	21.355	327571.124900	-2686584.652820	130-32-23	90-00-16	33.243
合計				倍面積 面積 坪數	651.193569 325.5967845 98.49	-651.193569 325.5967845 98.49			123.994

公共用地面積（座標法）計算書

画地番号： 6-4号(1)

測点名	[1] X(i)	[2] X(i+1)-X(i-1)	[3] Y(i)	[4] Y(i+1)-Y(i-1)	[2]*[3]	[1]*[4]	方向角	夾角	距離
K1	-125759.283	-30.051	-12794.721	5.097	384494.160771	-640995.065451	165-13-20	131-40-00	27.922
K95	-125786.281	-27.201	-12787.599	9.416	347835.480399	-1184403.621896	95-03-25	109-50-05	2.303
K94	-125786.484	-0.085	-12785.305	2.916	1086.750925	-366793.387344	79-15-29	164-12-04	0.633
K93	-125786.366	4.083	-12784.683	-0.427	-52199.860689	53710.778282	345-10-52	85-55-23	4.101
6-A1	-125782.401	14.155	-12785.732	-3.758	-180982.036460	472690.262958	345-06-44	179-55-52	10.544
1-B2	-125772.211	26.171	-12788.441	-6.964	-334686.289411	875877.677404	345-05-26	179-58-42	16.538
K2	-125756.230	12.928	-12792.696	-6.280	-165383.973888	789749.124400	213-33-20	48-27-54	3.664
合計					倍面積 164.231647	-164.231647			65.705
					面積 82.1158235	82.1158235			
					坪数 24.84	24.84			

公共用地面積（座標法）計算書

画地番号： 6-4号(2)

測点名	[1] X(i)	[2] X(i+1)-X(i-1)	[3] Y(i)	[4] Y(i+1)-Y(i-1)	[2]*[3]	[1]*[4]	方向角	夾角	距離
K87	-125810.340	-0.250	-12778.861	-2.902	3194.715250	365101.606680	265-04-35	85-04-35	2.913
K86	-125810.590	-9.514	-12781.763	-0.376	121605.693182	47304.781840	164-44-53	79-40-18	9.602
K85	-125819.854	-12.257	-12779.237	4.679	156635.107909	-588711.096866	144-16-15	159-31-22	3.687
K84	-125822.847	2.455	-12777.084	2.795	-31367.741220	-351674.857365	6-43-15	42-27-00	5.486
6-62	-125817.399	12.507	-12776.442	-1.777	-159794.960094	223577.518023	341-05-03	154-21-48	7.462
K87	-125810.340	7.059	-12778.861	-2.419	-90205.979799	304335.212460	0-00-00	198-54-57	0.000
合計				倍面積	66.835228	-66.835228			29.150
				面積	33.4176140	33.4176140			
				坪数	10.10	10.10			

公共用地面積（座標法）計算書

画地番号： 6-4号(3)

測点名	[1] X(i)	[2] X(i+1)-X(i-1)	[3] Y(i)	[4] Y(i+1)-Y(i-1)	[2]*[3]	[1]*[4]	方向角	夾角	距離
K84	-125822.847	-6.999	-12777.084	7.228	89426.810916	-909447.538116	101-08-56	94-25-41	8.021
K83	-125824.398	-3.028	-12769.214	21.913	38665.179992	-2757190.033374	96-00-15	174-51-19	14.120
K82	-125825.875	-4.606	-12755.171	18.611	58750.317626	-2341745.359625	124-24-38	208-24-23	5.537
K81	-125829.004	-1.597	-12750.603	7.548	20362.712991	-949757.322192	62-47-33	118-22-55	3.351
10-A	-125827.472	2.064	-12747.623	2.589	-26311.093872	-325767.325008	323-41-08	80-53-35	0.660
10-B	-125826.940	4.581	-12748.014	-6.845	-58398.652134	861285.404300	302-06-09	158-25-01	7.619
6-E	-125822.891	5.404	-12754.468	-20.121	-68925.145072	2531682.389811	275-39-43	153-33-34	13.734
6-F	-125821.536	3.373	-12768.135	-19.818	-43066.919355	2493531.200448	288-09-48	192-30-05	6.474
6-G1	-125819.518	4.137	-12774.286	-8.307	-52847.221182	1045182.736026	314-30-15	206-20-27	3.023
6-G2	-125817.399	-3.329	-12776.442	-2.798	42532.775418	352037.082402	186-43-15	52-13-00	5.486
合計					188.765328	-188.765328			68.025
				倍面積	94.3826640	94.3826640			
				面積	28.55	28.55			
				坪數					

公共用地面積（座標法）計算書

画地番号： 6-5号

測点名	[1] X(i)	[2] X(i+1)-X(i-1)	[3] Y(i)	[4] Y(i+1)-Y(i-1)	[2]*[3]	[1]*[4]	方向角	夾角	距離
6-B1	-125779.900	-2.143	-12744.299	-8.095	27311.032757	1018188.290500	134-45-27	44-54-11	3.007
6-B2	-125782.017	-32.359	-12742.164	2.228	412323.684876	-280242.333876	179-49-26	225-03-59	30.242
6-C	-125812.259	-29.994	-12742.071	98.395	382185.677574	-12379297.224305	89-51-20	90-01-54	98.302
8-A	-125812.011	15.865	-12643.769	106.850	-200593.395185	-13443013.375350	28-41-39	118-50-19	17.803
8-B	-125796.394	30.277	-12635.221	8.504	-382556.586217	-1069772.534576	359-49-41	151-08-02	14.660
8-C1	-125781.734	16.799	-12635.265	2.081	-212259.816735	-261751.788454	44-48-43	224-59-02	3.015
8-C2	-125779.595	2.100	-12633.140	-8.116	-26529.594000	1020827.193020	269-46-55	44-58-12	10.241
7-B1	-125779.634	-2.162	-12643.381	-8.112	27334.989722	1020324.391008	134-55-09	45-08-14	3.007
7-B2	-125781.757	-13.700	-12641.252	2.156	173185.152400	-271185.468092	179-51-59	224-56-50	11.577
7-C1	-125793.334	-14.473	-12641.225	-0.708	182956.449425	89061.680472	194-14-27	194-22-28	2.988
7-C2	-125796.230	-11.169	-12641.960	-5.272	141198.051240	663197.724560	208-44-27	194-30-00	9.435
7-D1	-125804.503	-9.796	-12646.497	-7.111	123885.084612	894595.820833	239-23-16	210-38-49	2.991
7-D2	-125806.026	-1.748	-12649.071	-87.484	22110.576108	11006014.378584	269-50-53	210-27-37	84.910
7-E1	-125806.251	1.886	-12733.981	-87.039	-24016.288166	10950050.280789	314-45-24	224-54-31	2.998
7-E2	-125804.140	24.238	-12736.110	-2.197	-308697.834180	276391.695580	359-49-26	225-04-02	22.127
7-A1	-125782.013	24.266	-12736.178	2.041	-309056.095348	-256721.088533	44-35-43	224-46-17	3.004
7-A2	-125779.874	2.113	-12734.069	-8.121	-26907.087797	1021458.356754	269-51-16	45-15-33	10.230
合計					1874.001086	-1874.001086			330.537
				倍面積	937.0005430	937.0005430			
				面積	283.44	283.44			
				坪数					

公共用地面積（座標法）計算書

画地番号： 6-6号

測点名	[1] X(i)	[2] X(i+1)-X(i-1)	[3] Y(i)	[4] Y(i+1)-Y(i-1)	[2]*[3]	[1]*[4]	方向角	夾角	距離
K51	-125848.884	1.570	-12488.552	7.554	-19607.026640	-950662.469736	76-50-16	139-39-58	7.488
K50	-125847.179	2.836	-12481.261	8.458	-35396.856196	-1064415.439982	45-53-51	149-03-35	1.625
K49-3	-125846.048	-1.570	-12480.094	-7.554	19593.747580	950641.046592	252-47-30	26-53-39	9.130
9-C	-125848.749	-2.836	-12488.815	-8.458	35418.279340	1064428.719042	117-10-18	44-22-48	0.296
合計									18.539
				倍面積	8.144084	-8.144084			
				面積	4.0720420	4.0720420			
				坪数	1.23	1.23			

公共用地面積(座標法)計算書

画地番号：水路1号

測点名	[1] X(i)	[2] X(i+1)-X(i-1)	[3] Y(i)	[4] Y(i+1)-Y(i-1)	[2]*[3]	[1]*[4]	方向角	夾角	距離
2-G	-125716.104	-1.965	-12678.584	-1.086	24913.417560	136527.688944	181-55-11	90-00-31	2.000
2-H1	-125718.103	-2.041	-12678.651	1.103	25877.126691	-138667.067609	92-03-21	90-08-10	1.171
2-H2	-125718.145	0.438	-12677.481	5.764	-5552.736678	-724639.387780	84-02-07	171-58-46	4.619
2-H3	-125717.665	-2.295	-12672.887	28.036	29084.275665	-3524620.455940	96-45-04	192-42-57	23.606
2-H4	-125720.440	-1.871	-12649.445	31.270	23667.111595	-3931278.158800	83-24-45	166-39-41	7.880
2-H5	-125719.536	7.198	-12641.617	23.486	-90994.359166	-2952649.022496	68-06-05	164-41-20	16.876
2-H6	-125713.242	1.727	-12625.959	40.264	-21805.031193	-5061717.975888	100-30-53	212-24-48	25.026
2-H25	-125717.809	-4.735	-12601.353	26.627	59667.406455	-3347488.100243	94-45-07	174-14-14	2.028
2-H22	-125717.977	-1.573	-12599.332	13.607	19818.749236	-1710644.513039	96-54-52	182-09-45	11.671
2-H12	-125719.382	-3.130	-12587.746	20.586	39399.644980	-2588059.197852	100-51-00	183-56-08	9.164
2-H13	-125721.107	-4.276	-12578.746	17.822	53786.717896	-2240601.568954	106-07-41	185-16-41	9.183
2-H14	-125723.658	-1.548	-12569.924	12.118	19458.242352	-1523519.287644	73-04-28	146-56-47	3.445
2-H15	-125722.655	-2.621	-12566.628	20.342	32937.131988	-2557450.248010	102-00-09	208-55-41	17.427
2-H16	-125726.279	-8.375	-12549.582	49.457	105102.749250	-6218044.580503	98-20-22	176-20-13	32.757
2-H17	-125731.030	-5.299	-12517.171	36.147	66328.489129	-4544799.541410	98-20-41	180-00-19	3.776
2-H18	-125731.578	-13.099	-12513.435	17.733	163913.485065	-2229598.072674	131-52-56	213-32-15	18.800
2-H19	-125744.129	-27.219	-12499.438	31.216	340222.202922	-3925228.730864	130-25-34	178-32-38	22.620
12-A	-125758.797	-13.447	-12482.219	18.870	167848.398893	-2373068.499390	53-30-55	103-05-21	2.053
2-H20	-125757.576	16.174	-12480.568	-15.903	-201860.706832	1999922.731128	310-25-31	76-54-36	23.059
K36	-125742.623	27.889	-12498.122	-31.980	-348560.124458	4021249.083540	311-52-59	181-27-28	19.377
K35	-125729.687	13.572	-12512.548	-18.759	-169820.301456	2358563.198433	278-21-01	146-28-02	4.379
K34	-125729.051	5.378	-12516.881	-36.680	-67315.786018	4611741.590680	278-20-24	179-59-23	32.693
K33	-125724.309	5.908	-12549.228	-37.833	-74140.839024	4756527.782397	281-59-57	183-39-33	5.609
K32	-125723.143	3.719	-12554.714	-17.496	-46690.981366	2199652.109928	282-00-03	180-00-06	12.278
K31	-125720.590	1.698	-12566.724	-14.811	-21338.297352	1862047.658490	253-01-31	151-01-28	2.929
K30	-125721.445	-0.052	-12569.525	-3.818	653.615300	480004.477010	308-17-38	235-16-07	1.296
K29	-125720.642	4.036	-12570.542	-17.893	-50734.707512	2249519.447306	280-50-42	152-33-04	17.183
K28	-125717.409	3.718	-12587.418	-19.720	-46800.020124	2479147.305480	279-40-40	178-49-58	2.885
K27	-125716.924	1.687	-12590.262	-14.221	-21239.771994	1787820.376204	276-01-52	176-21-12	11.440
K26	-125715.722	3.350	-12601.639	-22.940	-42215.490650	2883918.662680	280-31-25	184-29-33	11.761
K25	-125713.574	4.555	-12613.202	-24.528	-57453.135110	3083502.543072	280-31-03	179-59-38	13.187
K24	-125711.167	-4.002	-12626.167	-28.924	50529.920334	3636069.794308	248-07-12	147-36-09	17.198
K23	-125717.576	-7.256	-12642.126	-23.249	91731.266256	2922807.924424	263-22-22	195-15-10	7.339
K22	-125718.423	-0.395	-12649.416	-10.770	4996.519320	1353987.415710	277-24-02	194-01-40	3.509
K21	-125717.971	0.673	-12652.896	-5.362	-8515.399008	674099.760502	276-41-51	179-17-49	1.895
K20	-125717.750	0.968	-12654.778	-8.369	-12249.825104	1052131.849750	276-34-08	179-52-17	6.530
K19	-125717.003	2.109	-12661.265	-18.091	-26702.607885	2274346.301273	276-41-40	180-07-32	11.684
K18	-125715.641	0.865	-12672.869	-16.300	-10962.031685	2049164.948300	263-57-31	167-15-51	4.722
K17	-125716.138	-0.463	-12677.565	-5.715	5869.712595	718467.728670	271-54-40	187-57-09	1.020
合計				倍面積	854.030867	-854.030867			426.075
				面積	427.0154335	427.0154335			
				坪數	129.17	129.17			

公共用地面積（座標法）計算書

画地番号：水路2号

測点名	[1] X(i)	[2] X(i+1)-X(i-1)	[3] Y(i)	[4] Y(i+1)-Y(i-1)	[2]*[3]	[1]*[4]	方向角	夾角	距離
2-H25	-125717.809	-15.548	-12601.353	-2.252	195925.836444	283116.505868	180-50-32	86-05-25	15.718
2-H24	-125733.525	-15.707	-12601.584	1.769	197933.079888	-222422.605725	89-44-32	88-54-00	2.000
2-H23	-125733.516	15.548	-12599.584	2.252	-195898.332032	-283151.878032	0-55-45	91-11-13	15.541
2-H22	-125717.977	15.707	-12599.332	-1.769	-197897.707724	222395.101313	274-45-07	93-49-22	2.028
合計					倍面積 62.876576	-62.876576			35.287
					面積 31.4382880	31.4382880			
					坪數 9.51	9.51			