

画地確定原子一覽表

画地面積	496.48 m ²
------	-----------------------

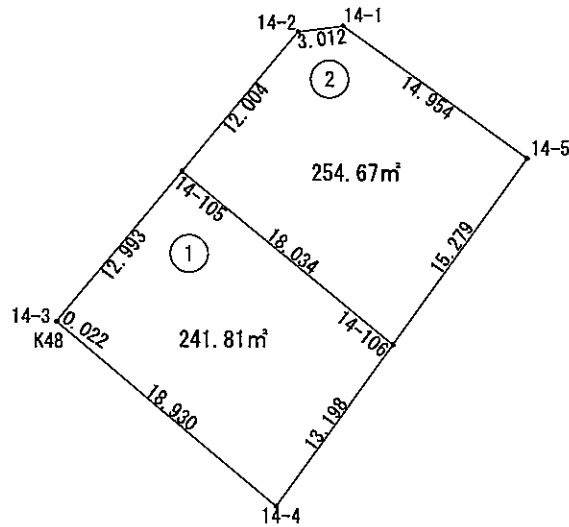
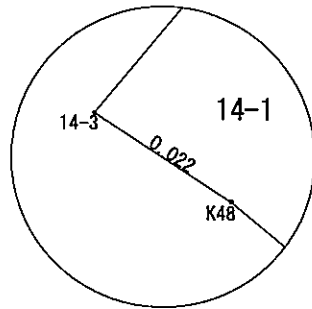
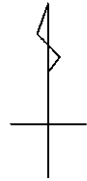

S=1:500

街区番号	14
------	----

令和 5 年 8 月

画地面積（座標法）計算書

画地番号： 14-1

測点名	[1] X(i)	[2] X(i+1)-X(i-1)	[3] Y(i)	[4] Y(i+1)-Y(i-1)	[2]*[3]	[1]*[4]	方向角	夾角	距離
14-4	-127176.672	-1.426	-12189.801	22.163	17382.656226	-2818616.581536	35-29-56	85-29-15	13.198
14-106	-127165.927	22.211	-12182.137	-6.255	-270577.444907	795422.873385	309-28-50	93-58-54	18.034
14-105	-127154.461	1.438	-12196.056	-22.181	-17537.928528	2820413.099441	219-29-06	90-00-16	12.993
14-3	-127164.489	-10.040	-12204.318	-8.244	122531.352720	1048344.047316	123-41-24	84-12-18	0.022
K48	-127164.501	-12.183	-12204.300	14.517	148684.986900	-1846047.061017	130-00-41	186-19-17	18.930
合計					倍面積 483.622411	-483.622411			63.177
					面積 241.8112055	241.8112055			
					地積 241.81	241.81			

画地面積（座標法）計算書

画地番号： 14-2

測点名	[1] X(i)	[2] X(i+1)-X(i-1)	[3] Y(i)	[4] Y(i+1)-Y(i-1)	[2]*[3]	[1]*[4]	方向角	夾角	距離
14-106	-127165.927	0.973	-12182.137	22.791	-11853.219301	-2898238.642257	35-29-53	86-01-03	15.279
14-5	-127153.488	21.126	-12173.265	-3.300	-257172.396390	419606.510400	305-30-54	90-01-01	14.954
14-1	-127144.801	8.292	-12185.437	-15.158	-101041.643604	1927260.893558	262-27-52	136-56-58	3.012
14-2	-127145.196	-9.660	-12188.423	-10.619	117740.166180	1350154.836324	219-29-01	137-01-09	12.004
14-105	-127154.461	-20.731	-12196.056	6.286	252836.436936	-799292.941846	129-28-50	89-59-49	18.034
合計					倍面積 509.343821	-509.343821			63.283
					面積 254.6719105	254.6719105			
					地積 254.67	254.67			

画地面積（座標法）計算書

画地番号： 緑地

測点名	[1] X(i)	[2] X(i+1)-X(i-1)	[3] Y(i)	[4] Y(i+1)-Y(i-1)	[2]*[3]	[1]*[4]	方向角	夾角	距離
15-1	-127179.879	39.838	-12136.287	-27.365	-483485.401506	3480277.388285	305-30-55	89-57-18	45.430
14-5	-127153.488	3.207	-12173.265	-53.514	-39039.660855	680491.756832	215-29-54	89-58-59	28.477
14-4	-127176.672	-28.838	-12189.801	-9.800	351529.481288	1246331.385600	130-00-33	94-30-39	8.794
K49	-127182.326	-25.638	-12183.065	29.958	212549.420470	-3810128.122308	130-42-51	180-42-18	30.637
K50	-127202.310	-18.359	-12159.843	24.882	223242.557637	-3101446.722420	35-31-16	84-48-25	1.997
K51	-127200.685	3.185	-12158.682	2.331	-38725.405355	-296504.796735	36-53-36	181-22-20	1.951
K52	-127199.125	2.394	-12157.512	1.715	-29105.083728	-218146.499375	33-06-56	176-13-20	0.996
K53	-127198.291	2.735	-12156.968	5.529	33249.307480	-703279.350939	125-36-02	272-29-06	6.131
K54	-127201.888	4.965	-12151.983	11.068	-60334.595595	-1407870.186480	35-28-52	89-52-50	10.480
K55	-127193.326	21.981	-12145.900	15.696	-266979.027900	-1996426.444896	35-33-37	180-04-45	16.530
合計					倍面積 2701.591886	-2701.591886			151.423
					面積 1350.7959430	1350.7959430			
					地積 1350.79	1350.79			