

画地確定原子一覽表

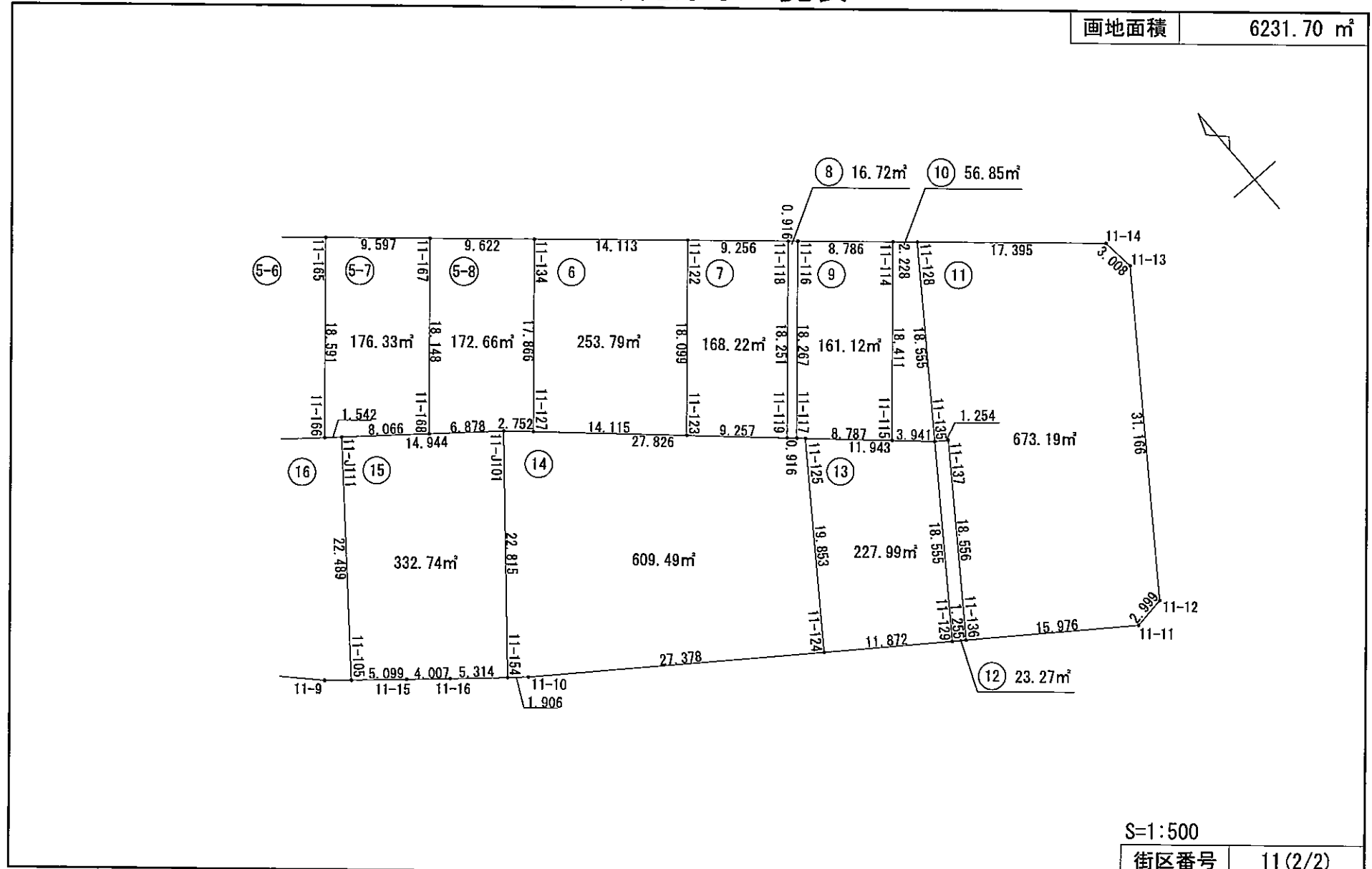

画地面積（座標法）計算書

画地番号： 11-1

測点名	[1] X(i)	[2] X(i+1)-X(i-1)	[3] Y(i)	[4] Y(i+1)-Y(i-1)	[2]*[3]	[1]*[4]	方向角	夾角	距離
11-146	-127049.726	8.412	-12253.781	-24.032	-103078.805772	3053259.015232	218-56-43	88-08-01	9.345
11-3	-127056.994	-10.675	-12259.655	-8.656	130871.817125	1099805.340064	219-14-01	180-17-18	4.399
11-4	-127060.401	-6.375	-12262.437	-2.352	78173.035875	298846.063152	171-45-23	132-31-22	2.999
11-5	-127063.369	-10.801	-12262.007	11.899	132441.937607	-1511927.027731	124-19-55	132-34-32	13.889
11-6	-127071.202	-13.639	-12250.538	16.365	167085.087782	-2079520.220730	139-51-37	195-31-42	7.595
11-144	-127077.008	5.796	-12245.642	14.915	-70975.741032	-1895353.574320	40-48-45	80-57-08	15.329
11-147	-127065.406	27.282	-12235.623	-8.139	-333812.266686	1034185.339434	310-48-42	89-59-57	23.991
合計					倍面積 705.064899	-705.064899			77.547
					面積 352.5324495	352.5324495			
					地積 352.53	352.53			

画地面積（座標法）計算書

画地番号： 11-2

測点名	[1] X(i)	[2] X(i+1)-X(i-1)	[3] Y(i)	[4] Y(i+1)-Y(i-1)	[2]*[3]	[1]*[4]	方向角	夾角	距離
11-148	-127041.270	7.456	-12246.948	-25.259	-91313.244288	3208935.438930	218-56-26	88-07-40	10.872
11-146	-127049.726	-24.136	-12253.781	11.325	295757.258216	-1438838.146950	130-48-42	91-52-16	23.991
11-147	-127065.406	-7.456	-12235.623	25.259	91228.805088	-3209545.090154	40-48-32	89-59-50	10.865
11-149	-127057.182	24.136	-12228.522	-11.325	-295147.606992	1438922.586150	310-48-46	90-00-14	24.346
合計					倍面積 525.212024	-525.212024			70.074
					面積 262.6060120	262.6060120			
					地積 262.60	262.60			

画地面積（座標法）計算書

画地番号： 11-3

測点名	[1] X(i)	[2] X(i+1)-X(i-1)	[3] Y(i)	[4] Y(i+1)-Y(i-1)	[2]*[3]	[1]*[4]	方向角	夾角	距離
11-145	-127051.161	20.703	-12223.322	-11.801	-253059.435366	1499330.750961	310-48-50	89-59-55	22.463
11-1	-127036.479	14.391	-12240.323	-19.989	-176150.488293	2539332.178731	264-26-15	133-37-25	3.002
11-2	-127036.770	-4.791	-12243.311	-6.625	58657.703001	841618.601250	218-56-45	134-30-30	5.786
11-148	-127041.270	-20.412	-12246.948	14.789	249984.702576	-1878813.342030	130-48-46	91-52-01	24.346
11-149	-127057.182	-9.891	-12228.522	23.626	120952.311102	-3001852.981932	40-48-55	90-00-09	7.956
合計					倍面積 384.793020	-384.793020			63.553
					面積 192.3965100	192.3965100			
					地積 192.39	192.39			

画地面積（座標法）計算書

画地番号： 11-4

測点名	[1] X(i)	[2] X(i+1)-X(i-1)	[3] Y(i)	[4] Y(i+1)-Y(i-1)	[2]*[3]	[1]*[4]	方向角	夾角	距離
11-151	-127056.486	17.766	-12217.155	4.577	-217049.975730	-581537.536422	310-48-34	89-59-44	8.148
11-145	-127051.161	-7.116	-12223.322	-16.910	86981.159352	2148435.132510	220-48-40	90-00-06	16.437
11-138	-127063.602	-17.766	-12234.065	-4.577	217350.398790	581570.106354	130-48-51	90-00-11	8.147
11-150	-127068.927	7.116	-12227.899	16.910	-87013.729284	-2148735.555570	40-48-50	89-59-59	16.438
合計					倍面積 267.853128	-267.853128			49.170
					面積 133.9265640	133.9265640			
					地積 133.92	133.92			

画地面積（座標法）計算書

画地番号： 11-5-1

測点名	[1] X(i)	[2] X(i+1)-X(i-1)	[3] Y(i)	[4] Y(i+1)-Y(i-1)	[2]*[3]	[1]*[4]	方向角	夾角	距離
11-155	-127062.759	18.714	-12209.891	3.480	-228495.900174	-442178.401320	310-48-47	89-59-57	9.598
11-151	-127056.486	-6.168	-12217.155	-18.008	75355.412040	2288033.199888	220-48-50	90-00-03	16.438
11-150	-127068.927	-18.714	-12227.899	-3.480	228832.901886	442199.865960	130-48-47	89-59-57	9.598
11-156	-127075.200	6.168	-12220.635	18.008	-75376.876680	-2288370.201600	40-48-50	90-00-03	16.438
合計					倍面積 315.537072	-315.537072			52.072
					面積 157.7685360	157.7685360			
					地積 157.76	157.76			

画地面積（座標法）計算書

画地番号： 11-5-2

測点名	[1] X(i)	[2] X(i+1)-X(i-1)	[3] Y(i)	[4] Y(i+1)-Y(i-1)	[2]*[3]	[1]*[4]	方向角	夾角	距離
11-158	-127081.799	8.282	-12213.653	15.560	-101153.474146	-1977392.792440	40-48-54	86-07-35	16.869
11-157	-127069.032	19.040	-12202.627	3.762	-232338.018080	-478033.698384	310-48-47	89-59-53	9.598
11-155	-127062.759	-6.168	-12209.891	-18.008	75310.607688	2288146.164072	220-48-50	90-00-03	16.438
11-156	-127075.200	-14.555	-12220.635	-8.296	177871.342425	1054215.859200	130-48-46	89-59-56	3.234
11-J19	-127077.314	-6.599	-12218.187	6.982	80627.816013	-887253.806348	134-41-19	183-52-33	6.377
合計				倍面積	318.273900	-318.273900			52.516
				面積	159.1369500	159.1369500			
				地積	159.13	159.13			

画地面積（座標法）計算書

画地番号： 11-5-3

測点名	[1] X(i)	[2] X(i+1)-X(i-1)	[3] Y(i)	[4] Y(i+1)-Y(i-1)	[2]*[3]	[1]*[4]	方向角	夾角	距離
11-160	-127089.063	11.127	-12207.244	14.092	-135830.003988	-1790939.075796	40-48-46	80-51-19	18.178
11-159	-127075.305	20.031	-12195.363	4.617	-244285.316253	-586706.683185	310-48-47	90-00-01	9.598
11-157	-127069.032	-6.494	-12202.627	-18.290	79243.859738	2324092.595280	220-48-54	90-00-07	16.869
11-158	-127081.799	-14.814	-12213.653	-8.956	180933.055542	1138144.591844	134-40-48	93-51-54	2.911
11-J17	-127083.846	-4.633	-12211.583	4.198	56576.264039	-533497.985508	140-32-57	185-52-09	3.349
11-J15	-127086.432	-5.217	-12209.455	4.339	63696.726735	-551428.028448	139-57-27	179-24-30	3.437
合計				倍面積	334.585813	-334.585813			54.342
				面積	167.2929065	167.2929065			
				地積	167.29	167.29			

画地面積（座標法）計算書

画地番号： 11-5-4

測点名	[1] X(i)	[2] X(i+1)-X(i-1)	[3] Y(i)	[4] Y(i+1)-Y(i-1)	[2]*[3]	[1]*[4]	方向角	夾角	距離
11-161	-127081.578	20.929	-12188.098	5.391	-255084.703042	-685096.786998	310-48-33	89-59-50	9.598
11-159	-127075.305	-7.485	-12195.363	-19.146	91282.292055	2432983.789530	220-48-46	90-00-13	18.178
11-160	-127089.063	-18.040	-12207.244	-8.283	220218.681760	1052678.708829	139-57-39	99-08-53	5.593
11-J141	-127093.345	-6.014	-12203.646	5.045	73392.727044	-641185.925525	140-07-23	180-09-44	2.257
11-J13	-127095.077	-2.889	-12202.199	2.892	35252.152911	-367558.962684	128-41-02	168-33-39	1.851
11-162	-127096.234	13.499	-12200.754	14.101	-164697.978246	-1792183.995634	40-48-43	92-07-41	19.364
合計				倍面積	363.172482	-363.172482			56.841
				面積	181.5862410	181.5862410			
				地積	181.58	181.58			

画地面積（座標法）計算書

画地番号： 11-5-5

測点名	[1] X(i)	[2] X(i+1)-X(i-1)	[3] Y(i)	[4] Y(i+1)-Y(i-1)	[2]*[3]	[1]*[4]	方向角	夾角	距離
11-163	-127087.852	20.645	-12180.834	5.147	-251473.317930	-654121.174244	310-49-03	90-00-11	9.598
11-161	-127081.578	-8.382	-12188.098	-19.920	102160.637436	2531465.033760	220-48-43	89-59-40	19.364
11-162	-127096.234	-18.129	-12200.754	-8.316	221187.469266	1056932.281944	128-40-04	87-51-21	5.559
11-J12	-127099.707	-5.989	-12196.414	7.509	73044.323446	-954391.699863	128-26-51	179-46-47	4.046
11-164	-127102.223	11.855	-12193.245	15.580	-144550.919475	-1980252.634340	40-48-52	92-22-01	18.988
合計				倍面積	368.192743	-368.192743			57.555
				面積	184.0963715	184.0963715			
				地積	184.09	184.09			

画地面積（座標法）計算書

画地番号： 11-5-6

測点名	[1] X(i)	[2] X(i+1)-X(i-1)	[3] Y(i)	[4] Y(i+1)-Y(i-1)	[2]*[3]	[1]*[4]	方向角	夾角	距離
11-166	-127108.196	8.098	-12185.721	19.675	-98679.968658	-2500853.756300	40-48-44	92-22-03	18.591
11-165	-127094.125	20.344	-12173.570	4.887	-247659.108080	-621108.988875	310-48-47	90-00-03	9.598
11-163	-127087.852	-8.098	-12180.834	-19.675	98640.393732	2500453.488100	220-48-52	90-00-05	18.988
11-164	-127102.223	-20.344	-12193.245	-4.887	248059.376280	621148.563801	128-26-41	87-37-49	9.607
合計				倍面積	360.693274	-360.693274			56.784
				面積	180.3466370	180.3466370			
				地積	180.34	180.34			

画地面積（座標法）計算書

画地番号： 11-5-7

測点名	[1] X(i)	[2] X(i+1)-X(i-1)	[3] Y(i)	[4] Y(i+1)-Y(i-1)	[2]*[3]	[1]*[4]	方向角	夾角	距離
11-168	-127114.132	8.758	-12178.167	18.208	-106656.386586	-2314494.115456	40-48-45	92-42-39	18.148
11-167	-127100.397	20.007	-12166.306	4.597	-243411.284142	-584280.525009	310-48-31	89-59-46	9.597
11-165	-127094.125	-7.799	-12173.570	-19.415	94941.672430	2467532.436875	220-48-44	90-00-13	18.591
11-166	-127108.196	-15.030	-12185.721	-10.944	183151.386630	1391072.097024	128-28-06	87-39-22	1.542
11-J111	-127109.155	-5.936	-12184.514	7.554	72327.275104	-960182.556870	128-06-06	179-38-00	8.066
合計				倍面積	352.663436	-352.663436			55.944
				面積	176.3317180	176.3317180			
				地積	176.33	176.33			

画地面積（座標法）計算書

画地番号： 11-5-8

測点名	[1] X(i)	[2] X(i+1)-X(i-1)	[3] Y(i)	[4] Y(i+1)-Y(i-1)	[2]*[3]	[1]*[4]	方向角	夾角	距離
11-134	-127106.687	19.812	-12159.024	4.395	-240894.583488	-558633.889365	310-49-11	90-00-26	9.622
11-167	-127100.397	-7.445	-12166.306	-19.143	90578.148170	2433082.899771	220-48-45	89-59-34	18.148
11-168	-127114.132	-17.979	-12178.167	-6.448	218951.264493	819631.923136	128-05-52	87-17-07	6.878
11-J101	-127118.376	-6.077	-12172.754	7.466	73973.826058	-949065.795216	131-45-35	183-39-43	2.752
11-127	-127120.209	11.689	-12170.701	13.730	-142263.323989	-1745360.469570	40-48-45	89-03-10	17.866
合計				倍面積	345.331244	-345.331244			55.266
				面積	172.6656220	172.6656220			
				地積	172.66	172.66			

画地面積（座標法）計算書

画地番号： 11-6

測点名	[1] X(i)	[2] X(i+1)-X(i-1)	[3] Y(i)	[4] Y(i+1)-Y(i-1)	[2]*[3]	[1]*[4]	方向角	夾角	距離
11-122	-127115.911	22.922	-12148.342	1.147	-278464.295324	-145801.949917	310-48-39	89-59-54	14.113
11-134	-127106.687	-4.298	-12159.024	-22.359	52259.485152	2841978.414633	220-48-45	90-00-06	17.866
11-127	-127120.209	-22.922	-12170.701	-1.147	278976.808322	145806.879723	131-45-18	90-56-33	14.115
11-123	-127129.609	4.298	-12160.171	22.359	-52264.414958	-2842490.927631	40-48-45	89-03-27	18.099
合計				倍面積	507.583192	-507.583192			64.193
				面積	253.7915960	253.7915960			
				地積	253.79	253.79			

画地面積（座標法）計算書

画地番号： 11-7

測点名	[1] X(i)	[2] X(i+1)-X(i-1)	[3] Y(i)	[4] Y(i+1)-Y(i-1)	[2]*[3]	[1]*[4]	方向角	夾角	距離
11-119	-127135.774	7.648	-12153.266	18.834	-92948.178368	-2394475.167516	40-48-51	89-03-17	18.251
11-118	-127121.961	19.863	-12141.337	4.924	-241163.376831	-625948.535964	310-48-58	90-00-07	9.256
11-122	-127115.911	-7.648	-12148.342	-18.834	92910.519616	2394101.067774	220-48-45	89-59-47	18.099
11-123	-127129.609	-19.863	-12160.171	-4.924	241537.476573	625986.194716	131-45-34	90-56-49	9.257
合計				倍面積	336.440990	-336.440990			54.863
				面積	168.2204950	168.2204950			
				地積	168.22	168.22			

画地面積（座標法）計算書

画地番号： 11-8

測点名	[1] X(i)	[2] X(i+1)-X(i-1)	[3] Y(i)	[4] Y(i+1)-Y(i-1)	[2]*[3]	[1]*[4]	方向角	夾角	距離
11-116	-127122.559	14.423	-12140.643	11.245	-175104.493989	-1429493.175955	310-45-02	89-56-14	0.916
11-118	-127121.961	-13.215	-12141.337	-12.623	160447.768455	1604660.513703	220-48-51	90-03-49	18.251
11-119	-127135.774	-14.423	-12153.266	-11.245	175286.555518	1429641.778630	131-43-37	90-54-46	0.916
11-117	-127136.384	13.215	-12152.582	12.623	-160596.371130	-1604842.575232	40-48-48	89-05-11	18.267
合計				倍面積	33.458854	-33.458854			38.350
				面積	16.7294270	16.7294270			
				地積	16.72	16.72			

画地面積（座標法）計算書

画地番号： 11-9

測点名	[1] X(i)	[2] X(i+1)-X(i-1)	[3] Y(i)	[4] Y(i+1)-Y(i-1)	[2]*[3]	[1]*[4]	方向角	夾角	距離
11-114	-127128.302	19.677	-12133.994	5.384	-238760.599938	-684458.777968	310-49-06	90-00-19	8.786
11-116	-127122.559	-8.082	-12140.643	-18.588	98120.676726	2362954.126692	220-48-48	89-59-42	18.267
11-117	-127136.384	-19.677	-12152.582	-5.384	239126.356014	684502.291456	131-45-25	90-56-37	8.787
11-115	-127142.236	8.082	-12146.027	18.588	-98164.190214	-2363319.882768	40-48-47	89-03-22	18.411
合計				倍面積	322.242588	-322.242588			54.251
				面積	161.1212940	161.1212940			
				地積	161.12	161.12			

画地面積（座標法）計算書

画地番号： 11-10

測点名	[1] X(i)	[2] X(i+1)-X(i-1)	[3] Y(i)	[4] Y(i+1)-Y(i-1)	[2]*[3]	[1]*[4]	方向角	夾角	距離
11-135	-127144.861	12.478	-12143.087	13.719	-151521.439586	-1744300.348059	35-30-56	83-45-19	18.555
11-128	-127129.758	16.559	-12132.308	9.093	-200898.888172	-1155990.889494	310-48-48	95-17-52	2.228
11-114	-127128.302	-12.478	-12133.994	-13.719	151407.977132	1744073.175138	220-48-47	89-59-59	18.411
11-115	-127142.236	-16.559	-12146.027	-9.093	201126.061093	1156104.351948	131-45-37	90-56-50	3.941
合計				倍面積	113.710467	-113.710467			43.135
				面積	56.8552335	56.8552335			
				地積	56.85	56.85			

画地面積（座標法）計算書

画地番号： 11-11

測点名	[1] X(i)	[2] X(i+1)-X(i-1)	[3] Y(i)	[4] Y(i+1)-Y(i-1)	[2]*[3]	[1]*[4]	方向角	夾角	距離
11-11	-127169.973	-8.793	-12139.842	15.963	106745.630706	-2030014.278999	80-38-06	135-07-10	2.999
11-12	-127169.485	25.860	-12136.883	21.059	-313859.794380	-2678062.184615	35-30-13	134-52-07	31.166
11-13	-127144.113	28.358	-12118.783	17.741	-343664.448314	-2255663.708733	353-08-40	137-38-27	3.008
11-14	-127141.127	14.355	-12119.142	-13.525	-173970.283410	1719583.742675	310-48-40	137-40-00	17.395
11-128	-127129.758	-3.734	-12132.308	-23.945	45302.038072	3044122.055310	215-30-56	84-42-16	18.555
11-135	-127144.861	-15.831	-12143.087	-9.758	192237.210297	1240679.553638	125-29-24	89-58-28	1.254
11-137	-127145.589	-15.831	-12142.066	-9.759	192221.046846	1240813.803051	215-31-05	270-01-41	18.556
11-136	-127160.692	-24.384	-12152.846	2.224	296334.996864	-282805.379008	125-30-56	89-59-51	15.976
合計				倍面積	1346.396681	-1346.396681			108.909
				面積	673.1983405	673.1983405			
				地積	673.19	673.19			

画地面積（座標法）計算書

画地番号： 11-12

測点名	[1] X(i)	[2] X(i+1)-X(i-1)	[3] Y(i)	[4] Y(i+1)-Y(i-1)	[2]*[3]	[1]*[4]	方向角	夾角	距離
11-129	-127159.963	-15.831	-12153.867	-9.759	192407.868477	1240954.078917	125-31-37	90-00-26	1.255
11-136	-127160.692	14.374	-12152.846	11.801	-174685.008404	-1500623.326292	35-31-05	89-59-28	18.556
11-137	-127145.589	15.831	-12142.066	9.759	-192221.046846	-1240813.803051	305-29-24	89-58-19	1.254
11-135	-127144.861	-14.374	-12143.087	-11.801	174544.732538	1500436.504661	215-31-11	90-01-47	18.555
合計				倍面積	46.545765	-46.545765			39.620
				面積	23.2728825	23.2728825			
				地積	23.27	23.27			

画地面積（座標法）計算書

画地番号： 11-13

測点名	[1] X(i)	[2] X(i+1)-X(i-1)	[3] Y(i)	[4] Y(i+1)-Y(i-1)	[2]*[3]	[1]*[4]	方向角	夾角	距離
11-135	-127144.861	23.056	-12143.087	1.871	-279971.013872	-237888.034931	311-45-31	96-14-20	11.943
11-125	-127136.907	-8.205	-12151.996	-20.443	99707.127180	2599059.789801	215-31-07	83-45-36	19.853
11-124	-127153.066	-23.056	-12163.530	-1.871	280442.347680	237903.386486	125-31-03	89-59-56	11.872
11-129	-127159.963	8.205	-12153.867	20.443	-99722.478735	-2599531.123609	35-31-11	90-00-08	18.555
合計				倍面積	455.982253	-455.982253			62.223
				面積	227.9911265	227.9911265			
				地積	227.99	227.99			

画地面積（座標法）計算書

画地番号： 11-14

測点名	[1] X(i)	[2] X(i+1)-X(i-1)	[3] Y(i)	[4] Y(i+1)-Y(i-1)	[2]*[3]	[1]*[4]	方向角	夾角	距離
11-125	-127136.907	34.690	-12151.996	-9.224	-421552.741240	1172710.830168	311-45-21	96-14-14	27.826
11-J101	-127118.376	0.949	-12172.754	-35.297	-11551.943546	4486897.317672	219-35-18	87-49-57	22.815
11-154	-127135.958	-18.785	-12187.293	-13.060	228938.299005	1660395.611480	129-07-28	89-32-10	1.906
11-10	-127137.161	-17.108	-12185.814	23.763	208474.905912	-3021160.356843	125-31-01	176-23-33	27.378
11-124	-127153.066	0.254	-12163.530	33.818	-3089.536620	-4300062.385988	35-31-07	90-00-06	19.853
合計					倍面積 1218.983511	-1218.983511			99.778
					面積 609.4917555	609.4917555			
					地積 609.49	609.49			

画地面積（座標法）計算書

画地番号： 11-15

測点名	[1] X(i)	[2] X(i+1)-X(i-1)	[3] Y(i)	[4] Y(i+1)-Y(i-1)	[2]*[3]	[1]*[4]	方向角	夾角	距離
11-105	-127126.812	-20.909	-12198.442	-10.000	255057.223778	1271268.120000	129-37-17	91-21-17	5.099
11-15	-127130.064	-5.793	-12194.514	7.026	70642.819602	-893215.829664	129-21-32	179-44-15	4.007
11-16	-127132.605	-5.894	-12191.416	7.221	71856.205904	-918024.540705	129-07-10	179-45-38	5.314
11-154	-127135.958	14.229	-12187.293	18.662	-173412.992097	-2372611.248196	39-35-18	90-28-08	22.815
11-J101	-127118.376	26.803	-12172.754	2.779	-326266.325462	-353261.966904	308-06-00	88-30-42	14.944
11-J111	-127109.155	-8.436	-12184.514	-25.688	102788.560104	3265179.973640	218-16-00	90-10-00	22.489
合計					倍面積 665.491829	-665.491829			74.668
					面積 332.7459145	332.7459145			
					地積 332.74	332.74			

画地面積（座標法）計算書

画地番号： 11-16

測点名	[1] X(i)	[2] X(i+1)-X(i-1)	[3] Y(i)	[4] Y(i+1)-Y(i-1)	[2]*[3]	[1]*[4]	方向角	夾角	距離
11-104	-127116.095	-25.559	-12209.324	-3.895	312058.112116	495117.190025	135-29-29	97-15-41	12.860
11-9	-127125.266	-10.717	-12200.309	10.882	130750.711553	-1383377.144612	129-37-37	174-08-08	2.424
11-105	-127126.812	16.111	-12198.442	15.795	-196529.099062	-2007967.995540	38-16-00	88-38-23	22.489
11-J111	-127109.155	27.105	-12184.514	2.028	-330261.251970	-257777.366340	308-26-52	90-10-52	15.195
11-J12	-127099.707	-6.940	-12196.414	-24.810	84643.113160	3153343.730670	218-13-48	89-46-56	20.862
合計					倍面積 661.585797	-661.585797			73.830
					面積 330.7928985	330.7928985			
					地積 330.79	330.79			

画地面積（座標法）計算書

画地番号： 11-17

測点名	[1] X(i)	[2] X(i+1)-X(i-1)	[3] Y(i)	[4] Y(i+1)-Y(i-1)	[2]*[3]	[1]*[4]	方向角	夾角	距離
11-103	-127107.341	-22.750	-12217.928	-5.678	277957.862000	721715.482198	135-29-42	89-54-56	12.274
11-104	-127116.095	7.634	-12209.324	21.514	-93205.979416	-2734775.667830	38-13-48	82-44-06	20.862
11-J12	-127099.707	21.018	-12196.414	7.125	-256344.229452	-905585.412375	308-40-19	90-26-31	7.410
11-J13	-127095.077	6.362	-12202.199	-7.232	-77630.390038	919151.596864	320-07-23	191-27-04	2.257
11-J141	-127093.345	-12.264	-12203.646	-15.729	149665.514544	1999051.223505	225-34-46	85-27-23	19.997
合計					倍面積 442.777638	-442.777638			62.800
					面積 221.3888190	221.3888190			
					地積 221.38	221.38			

画地面積（座標法）計算書

画地番号： 11-18

測点名	[1] X(i)	[2] X(i+1)-X(i-1)	[3] Y(i)	[4] Y(i+1)-Y(i-1)	[2]*[3]	[1]*[4]	方向角	夾角	距離
11-102	-127099.174	-22.845	-12225.955	-6.879	279301.941975	874315.217946	135-29-43	90-03-13	11.451
11-103	-127107.341	5.829	-12217.928	22.309	-71218.302312	-2835637.670369	45-34-46	90-05-03	19.997
11-J141	-127093.345	20.909	-12203.646	8.473	-255166.034214	-1076861.912185	319-57-35	94-22-49	9.030
11-J15	-127086.432	8.849	-12209.455	-7.403	-108041.467295	940820.856096	320-32-02	180-34-27	2.508
11-108	-127084.496	-12.742	-12211.049	-16.500	155593.186358	2096894.184000	225-26-30	84-54-28	20.920
合計					倍面積 469.324512	-469.324512			63.906
					面積 234.6622560	234.6622560			
					地積 234.66	234.66			

画地面積（座標法）計算書

画地番号： 11-19

測点名	[1] X(i)	[2] X(i+1)-X(i-1)	[3] Y(i)	[4] Y(i+1)-Y(i-1)	[2]*[3]	[1]*[4]	方向角	夾角	距離
11-101	-127091.979	-1.465	-12233.019	0.047	17921.372835	-5973.323013	139-34-26	139-36-52	0.071
11-8	-127092.033	-7.195	-12232.973	7.064	88016.240735	-897778.121112	135-29-52	175-55-26	10.012
11-102	-127099.174	7.537	-12225.955	21.924	-92147.022835	-2786522.290776	45-26-30	89-56-38	20.920
11-108	-127084.496	15.328	-12211.049	14.372	-187170.959072	-1826458.376512	320-35-44	95-09-14	0.841
11-J17	-127083.846	7.182	-12211.583	-7.138	-87703.589106	907124.492748	314-41-09	174-05-25	9.289
11-J19	-127077.314	6.543	-12218.187	-7.959	-79943.597541	1011408.342126	270-27-54	135-46-45	1.355
11-J20	-127077.303	-13.254	-12219.542	-14.833	161957.809668	1884937.635399	225-27-23	134-59-29	18.911
11-J8	-127090.568	-14.676	-12233.020	-13.477	179531.801520	1712799.584936	179-57-34	134-30-11	1.411
合計				倍面積	462.056204	-462.056204			62.810
				面積	231.0281020	231.0281020			
				地積	231.02	231.02			

画地面積（座標法）計算書

画地番号： 11-20

測点名	[1] X(i)	[2] X(i+1)-X(i-1)	[3] Y(i)	[4] Y(i+1)-Y(i-1)	[2]*[3]	[1]*[4]	方向角	夾角	距離
11-101	-127091.979	-0.714	-12233.019	1.791	8734.375566	-227621.734389	359-57-34	40-06-01	1.411
11-J8	-127090.568	14.676	-12233.020	13.477	-179531.801520	-1712799.584936	45-27-23	225-29-49	18.911
11-J20	-127077.303	13.254	-12219.542	14.833	-161957.809668	-1884937.635399	90-27-54	225-00-31	1.355
11-J19	-127077.314	1.775	-12218.187	-0.714	-21687.281925	90733.202196	310-48-05	40-20-11	2.733
11-152	-127075.528	-12.540	-12220.256	-16.624	153242.010240	2112503.577472	225-27-15	94-39-10	20.423
11-153	-127089.854	-16.451	-12234.811	-12.763	201274.875761	1622047.806602	139-51-33	94-24-18	2.780
合計				倍面積	74.368454	-74.368454			47.613
				面積	37.1842270	37.1842270			
				地積	37.18	37.18			

画地面積（座標法）計算書

画地番号： 11-21-1

測点名	[1] X(i)	[2] X(i+1)-X(i-1)	[3] Y(i)	[4] Y(i+1)-Y(i-1)	[2]*[3]	[1]*[4]	方向角	夾角	距離
11-152	-127075.528	21.083	-12220.256	6.731	-257639.657248	-855345.378968	310-48-53	85-21-38	10.338
11-170	-127068.771	-7.603	-12228.080	-20.224	92970.092240	2569838.824704	220-48-39	89-59-46	18.973
11-169	-127083.131	-21.083	-12240.480	-6.731	258066.039840	855396.554761	139-51-42	99-03-03	8.794
11-153	-127089.854	7.603	-12234.811	20.224	-93021.268033	-2570265.207296	45-27-15	85-35-33	20.423
合計				倍面積	375.206799	-375.206799			58.528
				面積	187.6033995	187.6033995			
				地積	187.60	187.60			

画地面積（座標法）計算書

画地番号： 11-21-2

測点名	[1] X(i)	[2] X(i+1)-X(i-1)	[3] Y(i)	[4] Y(i+1)-Y(i-1)	[2]*[3]	[1]*[4]	方向角	夾角	距離
11-170	-127068.771	19.529	-12228.080	6.415	-238802.174320	-815146.165965	310-48-57	90-00-18	7.908
11-138	-127063.602	-8.237	-12234.065	-17.562	100771.993405	2231490.978324	220-48-46	89-59-49	17.713
11-144	-127077.008	-19.529	-12245.642	-6.415	239145.142618	815199.006320	139-52-03	99-03-17	8.009
11-169	-127083.131	8.237	-12240.480	17.562	-100824.833760	-2231833.946622	40-48-39	80-56-36	18.973
合計				倍面積	290.127943	-290.127943			52.603
				面積	145.0639715	145.0639715			
				地積	145.06	145.06			