

画地確定原子一覽表

画地面積	556.95 m ²
------	-----------------------

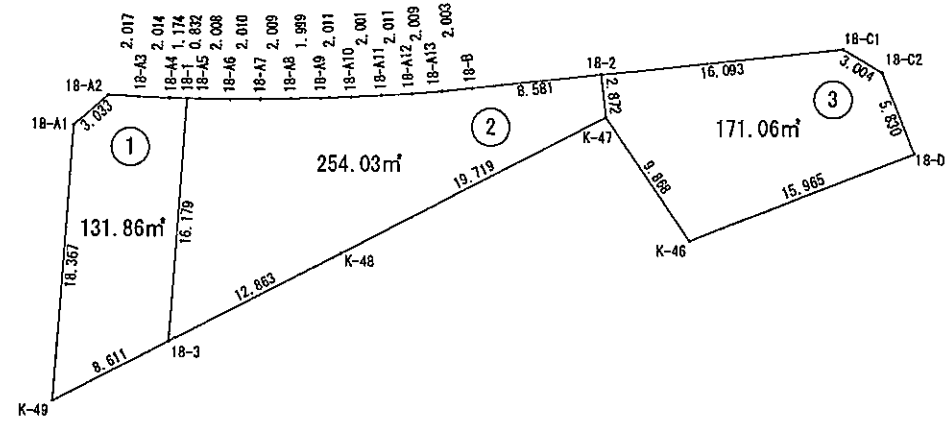
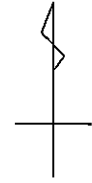

S=1:500

街区番号	18
------	----

平成 29 年 11 月

画地面積（座標法）計算書

画地番号： 18-1

測点名	[1] X(i)	[2] X(i+1)-X(i-1)	[3] Y(i)	[4] Y(i+1)-Y(i-1)	[2]*[3]	[1]*[4]	方向角	夾角	距離
K-49	-126707.285	-14.353	-12850.450	6.253	184442.508850	-792300.653105	62-36-49	58-15-50	8.611
18-3	-126703.324	20.093	-12842.804	8.873	-258050.460772	-1124238.593852	4-20-58	121-44-09	16.179
18-1	-126687.192	16.161	-12841.577	0.053	-207532.725897	-6714.421176	271-24-54	87-03-56	1.174
18-A4	-126687.163	0.109	-12842.751	-3.186	-1399.859859	403625.301318	272-16-37	180-51-43	2.014
18-A3	-126687.083	0.192	-12844.763	-4.026	-2466.194496	510042.196158	273-10-59	180-54-22	2.017
18-A2	-126686.971	-1.888	-12846.777	-4.294	24254.714976	543993.853474	228-44-35	135-33-36	3.033
18-A1	-126688.971	-20.314	-12849.057	-3.673	261015.743898	465328.590483	184-20-59	135-36-24	18.367
合計					倍面積 面積 地積	263.726700 -263.726700 131.86 131.86 131.86			51.395

画地面積（座標法）計算書

画地番号： 18_2

測点名	[1] X(i)	[2] X(i+1)-X(i-1)	[3] Y(i)	[4] Y(i+1)-Y(i-1)	[2]*[3]	[1]*[4]	方向角	夾角	距離
K-48	-126697.407	15.003	-12831.383	28.922	-192509.239149	-3664342.405254	62-33-47	179-57-03	19.719
K-47	-126688.321	11.942	-12813.882	17.199	-153023.378844	-2178912.432879	353-57-50	111-24-03	2.872
18-2	-126685.465	1.895	-12814.184	-8.829	-24282.878680	1118505.970485	263-34-11	89-36-21	8.581
18-B	-126686.426	-1.162	-12822.711	-10.520	14899.990182	1332741.201520	264-14-28	180-40-17	2.003
18-A13	-126686.627	-0.371	-12824.704	-3.995	4757.965184	506113.074865	265-08-47	180-54-19	2.009
18-A12	-126686.797	-0.301	-12826.706	-4.009	3860.838506	507887.369173	266-15-56	181-07-09	2.011
18-A11	-126686.928	-0.242	-12828.713	-4.005	3104.548546	507381.146640	266-49-13	180-33-17	2.001
18-A10	-126687.039	-0.194	-12830.711	-4.007	2489.157934	507634.965273	267-38-03	180-48-50	2.011
18-A9	-126687.122	-0.143	-12832.720	-4.007	1835.078960	507635.297854	268-16-48	180-38-45	1.999
18-A8	-126687.182	-0.103	-12834.718	-4.007	1321.975954	507635.538274	268-46-26	180-29-38	2.009
18-A7	-126687.225	-0.054	-12836.727	-4.019	693.183258	509155.957275	269-41-11	180-54-45	2.010
18-A6	-126687.236	0.013	-12838.737	-4.018	-166.903581	509029.314248	270-41-05	180-59-54	2.008
18-A5	-126687.212	0.044	-12840.745	-2.840	-564.992780	359791.682080	271-22-37	180-41-32	0.832
18-1	-126687.192	-16.112	-12841.577	-2.059	206903.488624	260848.928328	184-20-58	92-58-21	16.179
18-3	-126703.324	-10.215	-12842.804	10.194	131189.242860	-1291613.684856	62-36-44	58-15-46	12.863
合計					倍面積 面積 地積	508.076974 -508.076974 254.03 254.03 254.03			79.107

画地面積（座標法）計算書

画地番号： 18_3

測点名	[1] X(i)	[2] X(i+1)-X(i-1)	[3] Y(i)	[4] Y(i+1)-Y(i-1)	[2]*[3]	[1]*[4]	方向角	夾角	距離
K-47	-126688.321	-11.034	-12813.882	5.825	141388.373988	-737959.469825	145-58-01	152-00-11	9.868
K-46	-126696.499	-2.326	-12808.359	20.377	29792.243034	-2581694.560123	68-29-50	102-31-49	15.965
18-D	-126690.647	11.284	-12793.505	12.738	-144361.910420	-1613785.461486	338-43-01	90-13-11	5.830
18-C2	-126685.215	6.985	-12795.621	-4.687	-89377.412685	593773.602705	301-08-02	142-25-01	3.004
18-C1	-126683.662	-0.250	-12798.192	-18.563	3199.548000	2351628.817706	263-34-03	142-26-01	16.093
18-2	-126685.465	-4.659	-12814.184	-15.690	59701.283256	1987694.945850	173-57-50	90-23-47	2.872
合計					倍面積 面積 地積	342.125173 -342.125173 171.06 171.06 171.06			53.632