

# 画地確定原子一覽表

画地面積 1828.87 m<sup>2</sup>

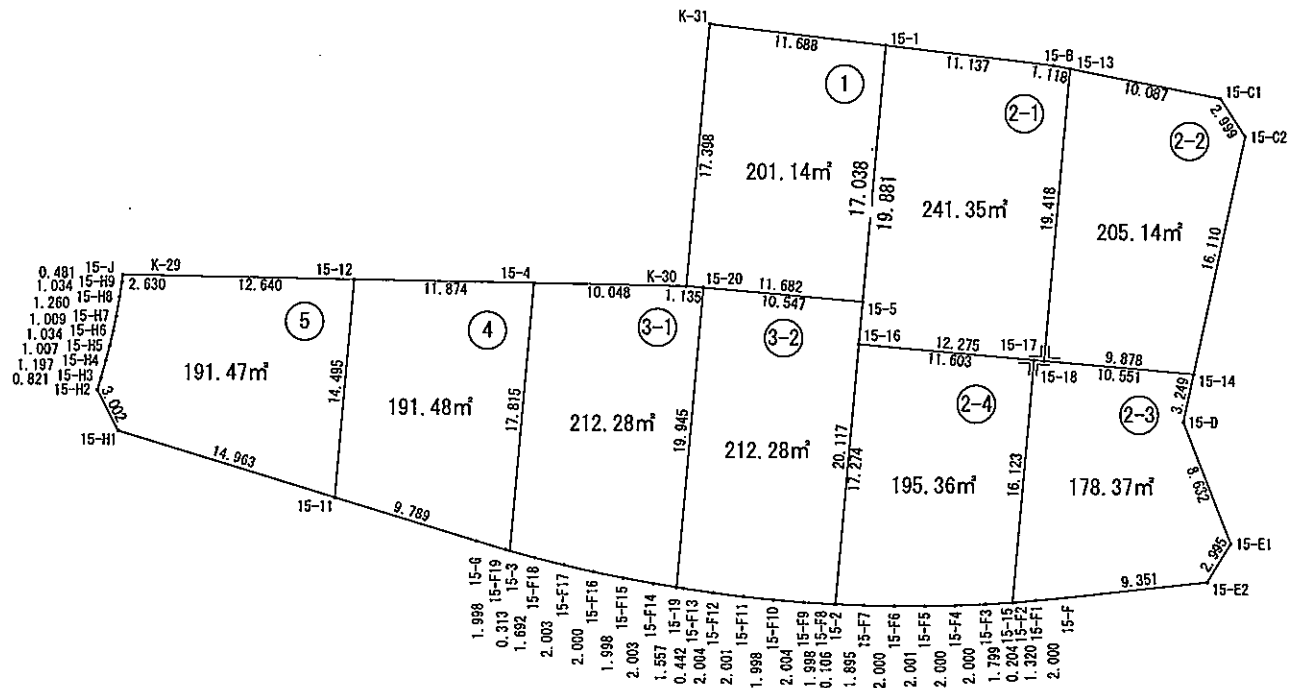
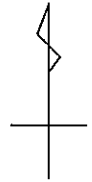

S=1:500

街区番号 15

平成 29 年 11 月

### 画地面積（座標法）計算書

画地番号： 15\_1

測点名	[1] X(i)	[2] X(i+1)-X(i-1)	[3] Y(i)	[4] Y(i+1)-Y(i-1)	[2]*[3]	[1]*[4]	方向角	夾角	距離
K-31	-126602.093	-15.970	-12851.141	-13.129	205232.721770	1662158.878997	185-00-56	88-19-42	17.398
K-30	-126619.424	-18.334	-12852.662	10.118	235640.705108	-1281135.332032	94-55-31	89-54-35	11.682
15-5	-126620.427	15.970	-12841.023	13.129	-205071.137310	-1662399.586083	5-01-01	90-05-30	17.038
15-1	-126603.454	18.334	-12839.533	-10.118	-235399.998022	1280973.747572	276-41-14	91-40-13	11.688
合計				倍面積	402.291546	-402.291546			57.806
				面積	201.14	201.14			
				地積	201.14	201.14			

### 画地面積（座標法）計算書

画地番号： 15\_2-1

測点名	[1] X(i)	[2] X(i+1)-X(i-1)	[3] Y(i)	[4] Y(i+1)-Y(i-1)	[2]*[3]	[1]*[4]	方向角	夾角	距離
15-13	-126604.966	19.560	-12827.375	0.569	-250903.455000	-72038.225654	281-02-19	96-07-00	1.118
15-B	-126604.752	1.512	-12828.472	-12.158	-19396.649664	1539260.574816	276-41-35	175-39-16	11.137
15-1	-126603.454	-18.507	-12839.533	-12.799	237621.237231	1620397.607746	185-00-55	88-19-20	19.881
15-16	-126623.259	-20.858	-12841.271	10.492	267843.230518	-1328531.233428	94-55-16	89-54-21	12.275
15-18	-126624.312	18.293	-12829.041	13.896	-234681.647013	-1759571.439552	4-55-19	90-00-03	19.418
合計				倍面積	482.716072	-482.716072			63.829
				面積	241.35	241.35			
				地積	241.35	241.35			

### 画地面積（座標法）計算書

画地番号： 15\_2-2

測点名	[1] X(i)	[2] X(i+1)-X(i-1)	[3] Y(i)	[4] Y(i+1)-Y(i-1)	[2]*[3]	[1]*[4]	方向角	夾角	距離
15-C2	-126609.406	18.263	-12815.832	1.724	-234055.539816	-218274.615944	326-46-53	134-43-03	2.999
15-C1	-126606.897	4.440	-12817.475	-11.543	-56909.589000	1461423.412071	281-02-13	134-15-20	10.087
15-13	-126604.966	-17.415	-12827.375	-11.566	223388.735625	1464313.036756	184-55-19	83-53-06	19.418
15-18	-126624.312	-20.194	-12829.041	8.176	259069.653954	-1035280.374912	94-55-28	90-00-09	9.878
15-14	-126625.160	14.906	-12819.199	13.209	-191082.980294	-1672591.738440	12-03-50	97-08-22	16.110
合計				倍面積	410.280469	-410.280469			58.492
				面積	205.14	205.14			
				地積	205.14	205.14			

### 画地面積（座標法）計算書

画地番号： 15\_2-3

測点名	[1] X(i)	[2] X(i+1)-X(i-1)	[3] Y(i)	[4] Y(i+1)-Y(i-1)	[2]*[3]	[1]*[4]	方向角	夾角	距離
15-E1	-126636.381	10.609	-12816.747	-1.585	-135972.868923	200718.663885	338-43-56	127-39-13	8.632
15-D	-126628.337	11.221	-12819.878	-2.452	-143851.851038	310492.682324	12-03-50	213-19-54	3.249
15-14	-126625.160	4.083	-12819.199	-9.833	-52340.789517	1245105.198280	274-55-34	82-51-44	10.551
15-17	-126624.254	-15.157	-12829.711	-11.896	194459.929627	1506322.125584	184-55-28	89-59-54	16.123
15-15	-126640.317	-16.050	-12831.095	-1.180	205939.074750	149435.574060	86-21-13	81-25-45	0.204
15-F2	-126640.304	0.132	-12830.891	1.519	-1693.677612	-192366.621776	84-49-45	178-28-32	1.320
15-F1	-126640.185	0.312	-12829.576	3.306	-4002.827712	-418672.451610	84-27-48	179-38-03	2.000
15-F	-126639.992	1.239	-12827.585	11.283	-15893.377815	-1428879.029736	83-34-38	179-06-50	9.351
15-E2	-126638.946	3.611	-12818.293	10.838	-46286.856023	-1372512.896748	31-04-43	127-30-05	2.995
合計				倍面積	356.755737	-356.755737			54.425
				面積	178.37	178.37			
				地積	178.37	178.37			

## 画地面積（座標法）計算書

画地番号： 15\_2-4

測点名	[1] X(i)	[2] X(i+1)-X(i-1)	[3] Y(i)	[4] Y(i+1)-Y(i-1)	[2]*[3]	[1]*[4]	方向角	夾角	距離	
15-17	-126624.254	17.058	-12829.711	-10.176	-218849.210238	1288528.408704	274-55-10	89-59-42	11.603	
15-16	-126623.259	-16.213	-12841.271	-13.071	208195.526723	1655092.618389	185-01-05	90-05-55	17.274	
15-2	-126640.467	-17.282	-12842.782	0.383	221948.958524	-48503.298861	92-14-15	87-13-10	1.895	
15-F7	-126640.541	-0.112	-12840.888	3.894	1438.179456	-493138.266654	91-05-19	178-51-04	2.000	
15-F6	-126640.579	-0.038	-12838.888	4.001	487.877744	-506688.956579	90-00-00	178-54-41	2.001	
15-F5	-126640.579	0.050	-12836.887	4.000	-641.844350	-506562.316000	88-34-02	178-34-02	2.000	
15-F4	-126640.529	0.147	-12834.888	3.997	-1886.728536	-506182.194413	87-13-14	178-39-12	2.000	
15-F3	-126640.432	0.212	-12832.890	3.793	-2720.572680	-480347.158576	86-20-03	179-06-49	1.799	
15-15	-126640.317	16.178	-12831.095	3.179	-207581.454910	-402589.567743	4-55-28	98-35-25	16.123	
合計					倍面積 面積 地積	390.731733 195.36 195.36			-390.731733 195.36 195.36	56.695

## 画地面積（座標法）計算書

画地番号： 15\_3-1

測点名	[1] X(i)	[2] X(i+1)-X(i-1)	[3] Y(i)	[4] Y(i+1)-Y(i-1)	[2]*[3]	[1]*[4]	方向角	夾角	距離	
15-4	-126619.258	-17.581	-12862.709	-11.605	226139.286929	1469416.489090	185-01-02	94-04-14	17.815	
15-3	-126637.005	-18.188	-12864.267	0.076	233975.288196	-9624.412380	105-06-13	100-05-11	1.692	
15-F18	-126637.446	-0.929	-12862.633	3.577	11949.386057	-452982.144342	104-05-55	178-59-42	2.003	
15-F17	-126637.934	-0.930	-12860.690	3.894	11960.441700	-493128.114996	102-45-54	178-39-59	2.000	
15-F16	-126638.376	-0.842	-12858.739	3.909	10827.058238	-495029.411784	101-32-46	178-46-52	1.998	
15-F15	-126638.776	-0.762	-12856.781	3.928	9796.867122	-497437.112128	100-24-44	178-51-58	2.003	
15-F14	-126639.138	-0.614	-12854.811	3.506	7892.853954	-443996.817828	99-19-02	178-54-18	1.557	
15-19	-126639.390	19.617	-12853.275	3.280	-252142.695675	-415377.199200	5-00-59	85-41-57	19.945	
15-20	-126619.521	19.966	-12851.531	0.613	-256593.667946	-77617.766373	274-54-07	89-53-08	1.135	
K-30	-126619.424	0.263	-12852.662	-11.178	-3380.250106	1415351.921472	270-56-48	176-02-41	10.048	
合計					倍面積 面積 地積	424.568469 212.28 212.28			-424.568469 212.28 212.28	60.196

## 画地面積（座標法）計算書

画地番号： 15\_3-2

測点名	[1] X(i)	[2] X(i+1)-X(i-1)	[3] Y(i)	[4] Y(i+1)-Y(i-1)	[2]*[3]	[1]*[4]	方向角	夾角	距離	
15-2	-126640.467	20.036	-12842.782	1.865	-257317.980152	-236184.470955	5-00-58	92-51-18	20.117	
15-5	-126620.427	20.946	-12841.023	-8.749	-268968.067758	1107802.115823	274-55-40	89-54-42	10.547	
15-20	-126619.521	-18.963	-12851.531	-12.252	243703.582353	1551342.371292	185-00-59	90-05-19	19.945	
15-19	-126639.390	-19.940	-12853.275	-1.308	256294.303500	165644.322120	99-14-57	94-13-58	0.442	
15-F13	-126639.461	-0.356	-12852.839	2.420	4575.610684	-306467.495620	98-10-28	178-55-31	2.004	
15-F12	-126639.746	-0.527	-12850.855	3.970	6772.400585	-502759.791620	96-56-51	178-46-23	2.001	
15-F11	-126639.988	-0.442	-12848.869	3.974	5679.200098	-503267.312312	95-44-41	178-47-50	1.998	
15-F10	-126640.188	-0.360	-12846.881	3.986	4624.877160	-504787.789368	94-34-43	178-50-02	2.004	
15-F9	-126640.348	-0.275	-12844.883	3.993	3532.342825	-505674.909564	93-17-57	178-43-14	1.998	
15-F8	-126640.463	-0.119	-12842.888	2.101	1528.303672	-266071.612763	92-09-40	178-51-43	0.106	
合計					倍面積 面積 地積	424.572967 212.28 212.28			-424.572967 212.28 212.28	61.162

## 画地面積（座標法）計算書

画地番号： 15\_4

測点名	[1] X(i)	[2] X(i+1)-X(i-1)	[3] Y(i)	[4] Y(i+1)-Y(i-1)	[2]*[3]	[1]*[4]	方向角	夾角	距離	
15-12	-126619.061	-14.243	-12874.581	-13.139	183372.657183	1663647.842479	185-00-52	94-03-50	14.495	
15-11	-126633.501	-17.298	-12875.848	8.095	222726.418704	-1025098.190595	106-58-34	101-57-42	9.789	
15-6	-126636.359	-3.422	-12866.486	11.279	44029.115092	-1428331.493161	106-23-40	179-25-06	1.998	
15-F19	-126636.923	-0.646	-12864.569	2.219	8310.511574	-281007.332137	105-11-27	178-47-47	0.313	
15-3	-126637.005	17.665	-12864.267	1.860	-227247.276555	-235544.829300	5-01-02	79-49-35	17.815	
15-4	-126619.258	17.944	-12862.709	-10.314	-230808.450296	1305951.027012	270-57-02	85-56-00	11.874	
合計					倍面積 面積 地積	382.975702 191.48 191.48			-382.975702 191.48 191.48	56.284

## 画地面積（座標法）計算書

画地番号： 15\_5

測点名	[1] X(i)	[2] X(i+1)-X(i-1)	[3] Y(i)	[4] Y(i+1)-Y(i-1)	[2]*[3]	[1]*[4]	方向角	夾角	距離
15-H2	-126626.459	-3.459	-12891.523	1.124	44591.778057	-142328.139916	152-58-26	135-58-26	3.002
15-H1	-126629.133	-7.042	-12890.159	15.675	90772.499678	-1984911.659775	106-58-24	133-59-58	14.963
15-11	-126633.501	10.072	-12875.848	15.578	-129685.541056	-1972696.678578	5-00-52	78-02-28	14.495
15-12	-126619.061	14.649	-12874.581	-11.371	-188599.737069	1439785.342631	270-56-51	85-55-59	12.640
K-29	-126618.852	0.253	-12887.219	-15.268	-3260.466407	1933216.632336	270-57-30	180-00-39	2.630
15-J	-126618.808	-0.434	-12889.849	-2.686	5594.194466	340098.118288	186-40-55	95-43-25	0.481
15-H9	-126619.286	-1.500	-12889.905	-0.210	19334.857500	26590.050060	188-34-09	181-53-14	1.034
15-H8	-126620.308	-2.263	-12890.059	-0.374	29170.203517	47355.995192	190-03-10	181-29-01	1.260
15-H7	-126621.549	-2.230	-12890.279	-0.418	28745.322170	52927.807482	191-19-16	181-16-06	1.009
15-H6	-126622.538	-1.996	-12890.477	-0.432	25729.392092	54700.936416	193-04-55	181-45-39	1.034
15-H5	-126623.545	-1.981	-12890.711	-0.490	25536.498491	62045.537050	194-43-34	181-38-39	1.007
15-H4	-126624.519	-2.129	-12890.967	-0.572	27444.868743	72429.224868	195-18-05	180-34-31	1.197
15-H3	-126625.674	-1.940	-12891.283	-0.556	25009.089020	70403.874744	197-00-00	181-41-55	0.821
合計				倍面積	382.959202	-382.959202			55.573
				面積	191.47	191.47			
				地積	191.47	191.47			